

Conduit location

Step by step



STEP 1

Locate Survey Pin. This pin is found either in-line or near your water meter and will be painted green.



STEP 2

Excavate turf on the footpath side of the verge to expose the end of the conduit then excavate on your property side of the footpath, locate conduit and dig a trench back to your water supply.

The conduit can be located directly below the level of the footpath.

Conduit location Step by step



STEP 3

Locate conduit under footpath.



STEP 4

Feed your irrigation line through the conduit.



STEP 5

Install your irrigation system.

Conduit location

Step by step

For more information on installing irrigation systems please follow these links:

[Bing Videos](#)



[How To Install An Irrigation System](#)



IMPORTANT

- Before commencing any works, a Verge Landscaping and Maintenance Application must be submitted and approved.
- All pipes, sprinklers and drippers must be Class 12 PVC or approved high-density polyethylene (HDPE) equivalent.
- Irrigation pipework must be installed in a manner that avoids disturbance to existing tree line irrigation infrastructure.
- Control valves, tap timers and wiring associated with automated irrigation systems must be located within private property boundaries.
- Any existing subsurface irrigation infrastructure, where present, has been decommissioned and must not be connected to or reused.
- Irrigation system design, including sprinkler placement and operation, must prevent overspray onto footpaths, driveways and crossovers.
- If you are uncertain about the location of underground services, contact **Before You Dig** Australia prior to undertaking any excavation works.

Conduit location Step by step

Verge Sprinkler

Verge turf typical irrigation layout

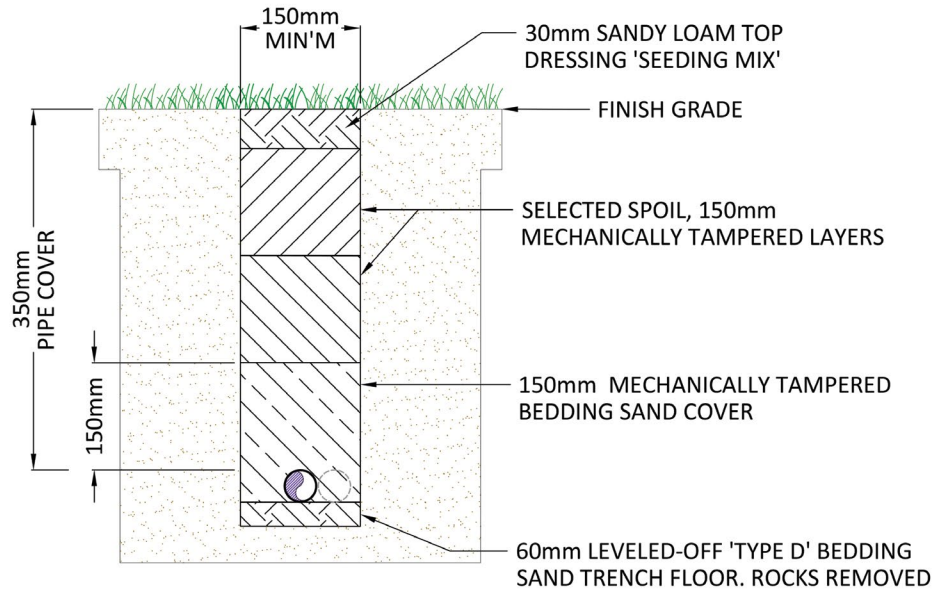

**MAINLINE / LATERAL TRENCH
TYPICAL INSTALLATION DETAIL**
(NOT TO SCALE)

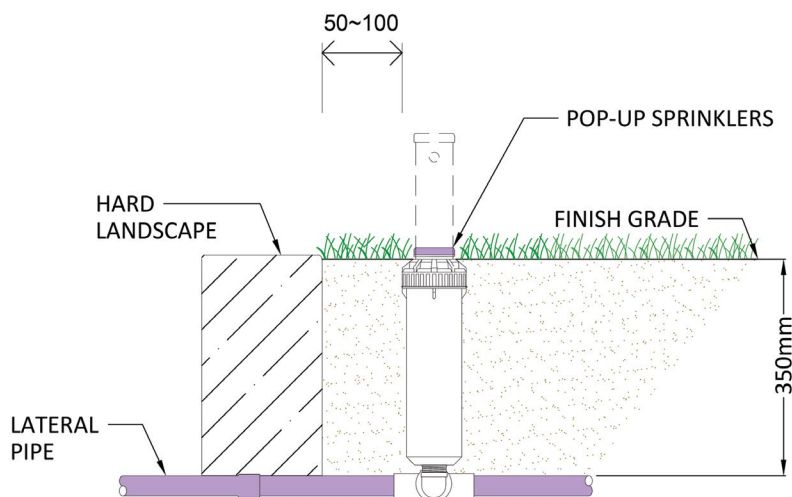

**POP-UP SPRINKLER
TYPICAL INSTALLATION DETAIL**
(NOT TO SCALE)

Conduit location Step by step

Verge Sprinkler

Verge turf typical irrigation layout

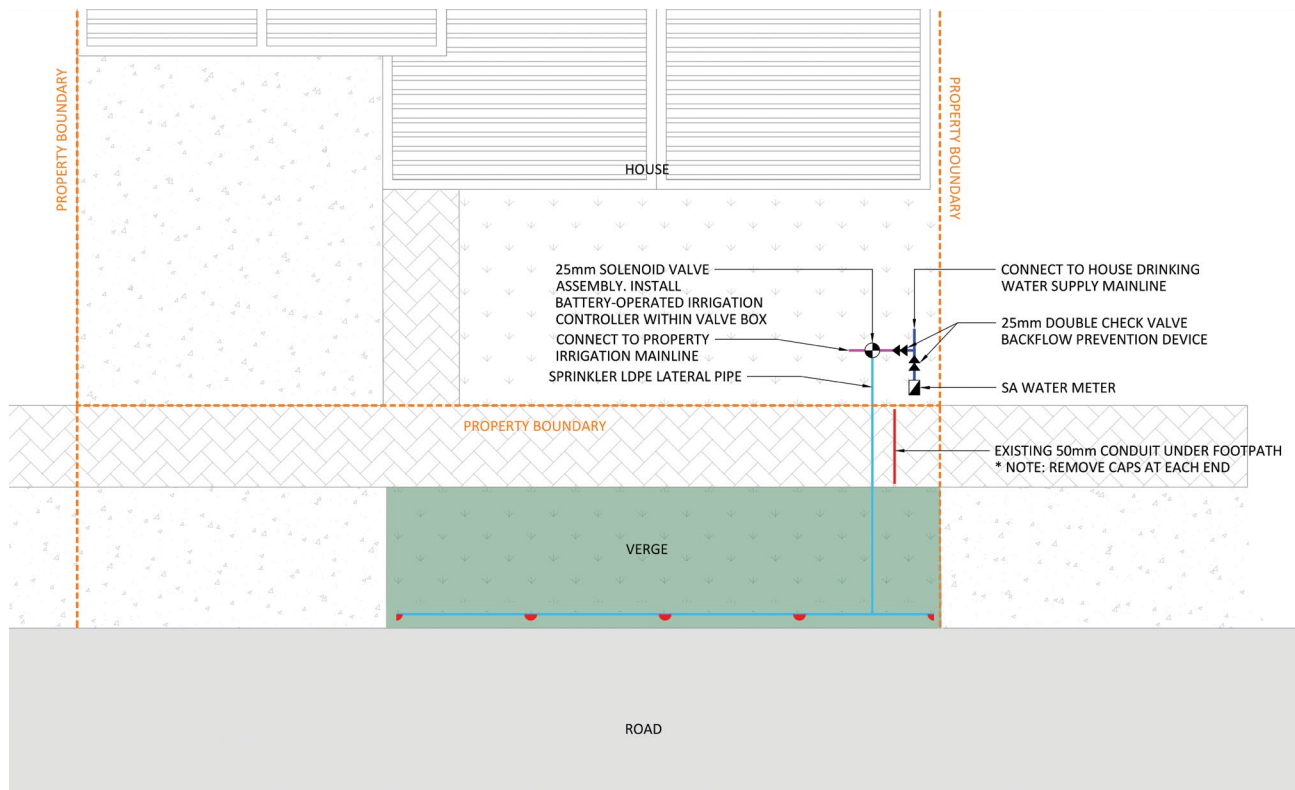

NOTES:

TOP SOIL AND INSTANT TURF TO BE INSTALLED BY DEVELOPER.

STREET TREES AND SUBSURFACE DRIP IRRIGATION TO STREET TREES INSTALLED BY DEVELOPER AND MANAGED BY THE CITY OF PLAYFORD (RECYCLED NON-DRINKING WATER, NOT TO BE MODIFIED)

REFER THE CITY OF PLAYFORD WEBSITE FOR FURTHER INFORMATION ON VERGE GUIDELINES AND MAINTENANCE

PRESSURE/FLOW TEST

PRIOR TO COMMENCEMENT OF WORKS THE IRRIGATION CONTRACTOR WILL BE REQUIRED TO CONDUCT A PRESSURE VS FLOW TEST IMMEDIATELY DOWNSTREAM OF THE WATER METER. IF THE TEST FAILS TO MEET THE REQUIRED SYSTEM DUTY AS SPECIFIED THE CONTRACTOR WILL INFORM THE SUPERINTENDENT OF THE RESULTS. THE SUPERINTENDENT WILL THEN DECIDE WHAT NECESSARY ACTIONS MAY BE REQUIRED.

IRRIGATION LEGEND

-  PN12.5 PE100 HDPE DRINKING WATER MAINLINE (SIZE TBC)
-  DN25 PN12.5 PE100 HDPE IRRIGATION WATER MAINLINE LILAC
-  25mm LDPE LATERAL LILAC PIPE
-  25mm SOLENOID VALVE ASSEMBLY FITTED WITH BATTERY-OPERATED IRRIGATION CONTROLLER
-  4" PLASTIC POP-UP SPRINKLER
-  25mm SA WATER METER
-  25mm DOUBLE CHECK VALVE BACKFLOW PREVENTION DEVICE
-  PVC DVW CONDUIT
-  PROPERTY BOUNDARY
-  TURF
-  DRIVEWAY
-  PATHWALK