



CITY OF PLAYFORD DOG AND CAT MANAGEMENT PLAN 2018 - 2023



Version 2. 24 November 2020.

© Images and content City of Playford

CONTENTS

1. Introduction	4
1.1 Executive Summary	5
1.2. Strategic Direction	6
1.3. Our Mission	7
1.4. Aims	7
1.5. Objectives And Strategies	8
1.6. Resources	10
1.7. Review	10
2. Legislative Requirements	11
2.1. Responsibilities	13
3. Description Of Area	14
4. Statistics	17
4.1. City Of Playford Statistics	18
4.2. South Australian Statistics	19
5. City Of Playford And Animal Management	20
5.1. Animal Welfare League Pound/Shelter	21
6. Cats	24
6.1. Cat Legislation	25
6.2. Cat Bylaw And Permits	26
6.3. Catteries	26
6.4. Cat Nuisance	26
7. Dogs	27
7.1. Dog By-Law And Permits	28
7.2. Community Education	30
7.3. Enforcement	31
7.4. South Australian Standards And Guidelines For Breeding and Trading Companion Animals	33
7.5. DACO	
7.6. Open Space	34
7.7. Planning For Pets	35
 Appendix 1 - Action Plan	
Appendix 2 - On / Off Leash areas	
Appendix 3 - Maps	

1. INTRODUCTION

The City of Playford Dog and Cat Management Plan has been prepared in order to provide a planned approach to responsibilities under the Dog and Cat Management Act 1995, and will guide dog and cat management within our community over the next five years.



1.1 EXECUTIVE SUMMARY

Dog and Cat Management plays a vital role in community safety, city enjoyment and participation in public life. This Plan outlines services and programs which Council will deliver to the community using a Smart City, Connected Community approach.

Legislative reform, regional growth and digital innovation offer opportunities to optimise Council's regulatory role. Council is committed to improving the way we do business. Our Smart City, Connected Community agenda will enable a more efficient and accessible service for a more active and educated community.

1.2 STRATEGIC DIRECTION

The City of Playford Dog and Cat Management Plan identifies strategies and actions to implement the mission, aims and objectives for dog and cat management, and relates these back to the wider Council planning architecture. The strategies within this plan have been prepared by the Health, Environment & Regulatory Services Department who are responsible for dog and cat management within the City of Playford. This plan has been conceived by drawing information from a broad range of stakeholders.

This Plan contains recommendations for a wide range of actions to be undertaken by Council. These actions will enable the City of Playford Regulatory Services Team to maintain a balance between operational requirements and future directions in relation to domestic dog and cat management. The plan emphasises a proactive combination of education, prevention, encouragement and enforcement.

This 5 year Plan has a focus on dogs and cats as they represent the most significant number and type of animals, and have the most significant impact on our community, our environment and our health and wellbeing.

July 2017 saw the introduction of several new amendments to the Dog and Cat Management Act. These new amendments are the first round of two of significant changes to the Act for the past 20 years.

To prepare for these changes the City of Playford has for the last 12 month period trained staff, amended systems and updated governance to ensure are ready for the effective administration of the Act going forward.

The strategies within this plan have been prepared by the Health, Environment & Regulatory Services Department who are responsible for dog and cat management within the City of Playford.



1.3 OUR MISSION

Our mission is to promote and facilitate responsible pet ownership including animal welfare and the benefits of animal companionship. To recognise that companion animals are part of the community and contribute to our quality of life.

To this end we will endeavour to enhance awareness of the needs of pets and the responsibilities of their owners whilst respecting the rights of non-pet owners and recognising the need to protect the environment.

1.4. AIMS

- Promote responsible pet ownership;
- Provide for the welfare and safety of dogs and cats;
- Ensure public safety;
- Protect native fauna and flora from the impact of dogs and cats;
- Harness the benefits of dog and cat ownership and acknowledge the importance of dogs and cats in society;
- Focus the expenditure of registration fees towards improving dog ownership and dog responsibility within our council area;
- Encourage education and community awareness;
- Provide effective management and a suitable environment for dogs and cats within the community.



1.5.

OBJECTIVES AND STRATEGIES

1.5.1.

PROVIDE EFFECTIVE MANAGEMENT AND A SUITABLE ENVIRONMENT FOR DOGS AND CATS WITHIN THE COMMUNITY.

- A. Encourage education of dog and cat owners and non-pet owners.
- B. Maximise dog and cat registration.
- C. Minimise dogs and cats wandering at large.
- D. Promote identification and desexing.
- E. Report all dog attacks.
- F. Identify suitable dog on/off leash, dog free and dog park activity areas.
- G. Maximise the understanding of City of Playford's role in dog and cat management.
- H. Limit the number of dogs and cats per dwelling.
- I. Maintain and analyse animal management data to ensure community needs are being addressed.
- J. Plan for the effective integration of pets into existing and new development.
- K. Identify proactive cat management initiatives.
- L. Implement the use of Dogs And Cats Online, (DACO), within Council and by the community.



"Georgia"
Winner 2017 Pups of Playford

1.5.2. ENCOURAGE RESPONSIBLE DOG AND CAT OWNERSHIP.

- A.** Provide education material to residents and visitors to the City of Playford.
- B.** Enforce the provisions of the Dog and Cat Management Act 1995.
- C.** Engage with residents through proactive community based social marketing to improve knowledge and the registration rate in our community.

1.5.3 REDUCE PUBLIC AND ENVIRONMENTAL NUISANCE CAUSED BY DOGS AND CATS.

- A.** Reduce the detrimental impacts of dogs i.e. barking dogs, dog attacks/harassment, dog faeces in public places.
- B.** Reduce the detrimental impacts of cats i.e. nuisance caused by cats, cat faeces in public places and destruction of wildlife.
- C.** Engage and form partnerships with other agencies to ensure all skill sets and resources are used when addressing these issues.

1.5.4. PROVIDE FOR THE WELFARE AND SAFETY OF DOGS AND CATS.

- A.** Identified wandering/impounded dogs and cats to be returned to their owners as soon as practical.
- B.** Impounded dogs and cats have clean safe facilities while impounded.
- C.** Ensure the City of Playford takes advantage of these times to ensure compliance and responsible animal ownership through education, information and possibly Council assistance.

1.5.5. ACKNOWLEDGE THE IMPORTANCE OF DOGS AND CATS IN SOCIETY.

- A.** Provide up to date information regarding the benefits of responsible dog and cat ownership.

1.5.6. MINIMISE PUBLIC RISK.

- A.** Conduct regular patrols of the City of Playford to ensure compliance with Legislative requirements.

1.5.7

PROTECT NATIVE FAUNA AND FLORA FROM THE IMPACT OF DOGS AND CATS

- A. Clearly define areas unsuitable for dog and cat recreation and exercise.
- B. Make available educational information on the detrimental effects of cats on native fauna.

1.5.8.

EXPENDITURE OF REGISTRATION FEES IN THE ADMINISTRATION OR ENFORCEMENT OF THE PROVISIONS OF THE DOG AND CAT MANAGEMENT ACT 1995 RELATING TO DOGS.

- A. Conduct regular reviews of income and expenditure to ensure best practice with available funds.

1.5.9.

PLAN FOR INTEGRATION OF DOGS AND CATS INTO URBAN ENVIRONMENTS

- A. Include integration of dogs and cats into urban environments, particularly with new residential housing, retirement developments and recreational areas through informed decision-making and planning that accounts for the popularity, value and place of pets in society.

1.6

RESOURCES

The funding of this Plan will be in accordance with the Annual Budget of the Council through the recurrent and project process. This will determine the rate of implementation. Individual initiatives have budget estimations detailed in the Action Plan.

Section 26 (3) of the Dog and Cat Management Act 1995 requires that 'money received by a Council under this Act must be expended in the administration or enforcement of the provisions of this Act relating to dogs and cats'.

Expenditure for the administration and enforcement of the Dog & Cat Management Act is presently derived from four principal sources, ie: general rate revenue, dog registration, expiation fees and fines for breaches of the Act. Dog registration and expiation fees are applied under the Act, whilst fines are applied as a result of court action.

1.7

REVIEW

The Dog and Cat Management Plan will be reviewed on an annual basis.

2. LEGISLATIVE REQUIREMENTS



The Dog and Cat Management Act was enacted in 1995 and brought in a new legal framework to South Australia covering both dogs and cats. The main objectives of the Dog and Cat Management Act 1995 being:

- Encourage responsible dog and cat ownership.
- Reduce public and environmental nuisance caused by dogs and cats.
- To promote the effective management of dogs and cats.

Animal control has changed substantially since the introduction of the Dog and Cat Management Act 1995. In light of that, and with a focus on animal welfare, South Australia's legislative and regulatory framework was reviewed and amended to improve the management of dogs and cats in our community. The Dog and Cat Miscellaneous Bill 2016 was developed and its reforms became law in 2017.

The new Act promotes responsible ownership of dogs and cats. There are two key changes in this area.

First there is the introduction of mandatory microchipping of all cats and dogs from 1 July 2018. The second is the introduction of mandatory de-sexing for all cats and dogs born after 1st July 2018. There are limited exemptions from both microchipping and de-sexing but in the future the expectation is that the vast majority of dogs and cats will be both microchipped and de-sexed.

From 1 July 2017 all breeders of dogs and cats must be registered with the Dog and Cat Management Board.

Knowledge of both animal and human behaviour is now a requirement of those working in the field. There is growing recognition that enforcement of laws will not, on its own, result in lasting, voluntary changes in behaviour. The law needs to be supplemented by a range of non-regulatory approaches such as public education, inclusion of integration of domestic pets into new residential development, improved signage, partnerships with animal welfare agencies and other initiatives.

There is now considerable evidence to support our understanding of the benefits of owning pets. There is a role for Council in harnessing the benefits of pet ownership or at least maintaining the ability of the community to continue to own dogs and cats. This links to Council's role in the development and implementation of health initiatives under the Public Health Act 2011. In this new environment, it is essential that Council take a strategic approach to managing domestic pets.

This strategy will provide the Council with a sound basis and direction from which it can plan, co-ordinate and make future decisions to meet the needs of the community over the next 5 years.

Dog registration has been simplified

Your dog now falls under one of these simple categories.

Standard Dog

A dog that is both desexed and microchipped

Non-standard Dog

All other dogs, even if they are exempt from rules around desexing or microchipping (i.e. dogs belonging to registered breeders, working livestock dogs etc).

Speak to your council about what rebates might apply to you, including training rebates.

For more information on dog management in SA, visit gooddogs.com.au

**DOG AND CAT
BOARD**



2.1. RESPONSIBILITIES

The responsibilities for dog and cat management in South Australia are prescribed in the Dog and Cat Management Act 1995. Councils are required by the Act to administer and enforce the provisions relating to dogs within its area. Prescribed responsibilities include the appointment of a Registrar, maintenance of a dog register, the appointment of dog management officers, detention of dogs seized, penalties that can be imposed on dog owners for non-compliance and various other obligations.

The provisions in relation to cat management were extended in the Dog and Cat Management Act (Miscellaneous) Amendment Bill 2016 to promote and facilitate responsible cat ownership and address the impact of cat ownership on the wider community.

A council is also able to make By-Laws relating to the specific management of issues for dogs and cats within its area.

From 1 July 2018 City of Playford is required to pay 24% of dog registration fees to the Dog and Cat Management Board each year.

The remainder of registration fees collected must be expended in the administration or enforcement of the provisions of the Dog and Cat Management Act 1995 relating to dogs and cats.

The Dog and Cat Management Act 1995 also provides for the appointment of the Dog and Cat Management Board, which has responsibility for the following:

- To plan, promote, and advise on effective management of dogs and cats in the State;
- To monitor councils management of their responsibilities;
- To issue guidelines for councils,
- To advise and assist Councils to undertake their responsibilities;
- To provide advice to the Minister;
- To keep the Act under review;
- To undertake research into companion animal management and;
- To provide education programs for officers dealing in dog and cat management and community awareness information.

Some of the actions within this plan are dictated by other State Government legislation and By-Laws including:

- Local Government Act 1999
- Impounding Act 1920
- Local Nuisance and Litter Control Act 2016
- Public Health Act 2011
- Council By-Law no. 1 – Permits and Penalties
- Council By-Law no. 3 – Local Government Land
- Council By-Law no. 4 – Dogs
- Council By-Law no. 5 – Cats

Note: The Dog and Cat Management Act is the primary Legislation, By-Laws introduced by Council are subordinate Legislation.



3. DESCRIPTION OF AREA



The City of Playford covers 345 square kilometres with approximately 85% of land considered open space and is the third largest council area in metropolitan Adelaide but has the second lowest population per hectare. Playford is bounded by the District Councils of Mallala and Light, the Town of Gawler and the Barossa Council to the north, the Adelaide Hills Council to the east, the Cities of Salisbury and Tea Tree Gully to the south and Gulf St Vincent to the west.

The City includes the suburbs and localities of Andrews Farm, Angle Vale, Bibaringa, Blakeview, Buckland Park, Craigmore, Davoren Park, Edinburgh North, Elizabeth, Elizabeth Downs, Elizabeth East, Elizabeth Grove, Elizabeth North, Elizabeth Park, Elizabeth South, Elizabeth Vale, Eyre, Gould Creek, Hillbank, Humbug Scrub, MacDonald Park, Munno Para, Munno Para Downs, Munno Para West, One Tree Hill, Penfield, Penfield Gardens, Sampson Flat, Smithfield, Smithfield Plains, Uleybury, Virginia, Waterloo Corner and Yattalunga.

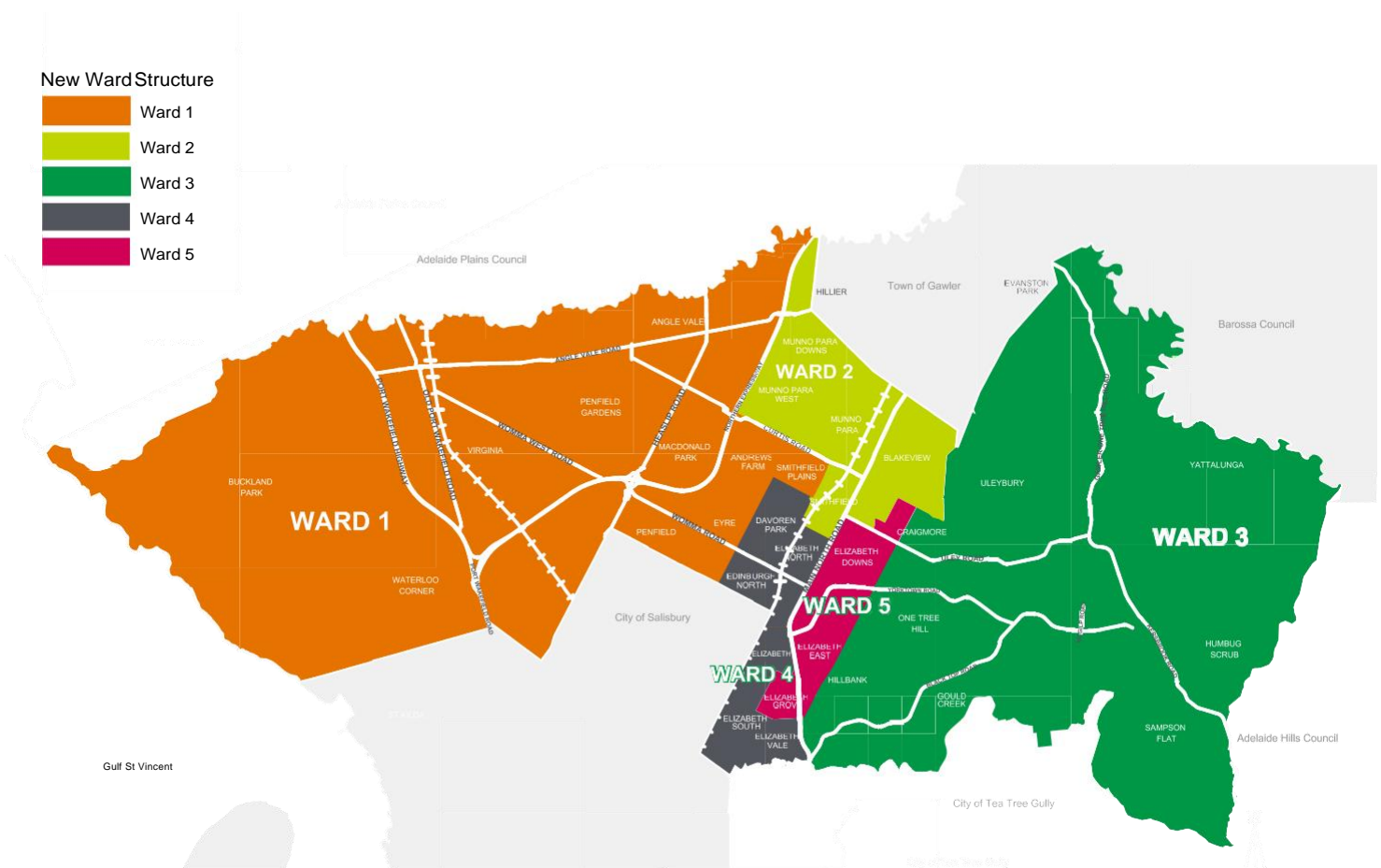

The City's boundaries are the Gawler River, Wingate Road, Dalkeith Road, Smith Road and the South Para River in the north, Bassnet Road in the east, Airstrip Road, Hannaford Hump Road, One Tree Hill Road, Gould Creek, Little Para River, Prunus Avenue, Jarvis Road, Porter Street, Commercial Road, the Gawler railway line, the northern boundary of the Defence Science and Technology Organisation facility and the Edinburgh RAAF Base, Heaslip Road and a line to the north of St Kilda in the south and Gulf St Vincent in the west.

New ward structure indicated above is effective from September 2018.



4. STATISTICS



Fremont Park, Elizabeth

4.1.

CITY OF PLAYFORD STATISTICS

	2015/16	2016/17
REGISTERED DOGS	16,691	16,570
IMPOUNDED DOGS	1108	954
RETURNED TO OWNER	616	532
DOG ATTACK - ANIMAL	103	115
DOG ATTACK - PERSON	64	95
DOG HARASSMENT	29	22
DOG WANDERING AT LARGE	1605	1614
DOG NOISE COMPLAINTS	275	210
CAT NUISANCE COMPLAINTS	88	81
INCOME FROM DOG REGISTRATIONS	\$490,000	\$505,000
INCOME FROM DOG EXPIATIONS	\$110,000	\$115,000
EXPENDITURE	\$988,225	\$1,011,129
DCMB CONTRIBUTION (20%)	\$100,751	\$107,477



4.2.

SOUTH AUSTRALIAN STATISTICS

Number of dogs registered in South Australia**

	Metropolitan	Country	Total
2016-17	183,536	108,511	292,047
2015-16	184,617	110,998	295,615
2014-15	185,674	112,183	297,857
2013-14	183,195	112,776	295,965

Number of dog attacks/harassments in South Australia**

	Total
2016-17	2313
2015-16	2179
2014-15	2000
2013-14	2061

- Harassment is defined as a dog troubling or annoying a person without being the primary cause of injury, i.e. the dog may chase a person or animal but not bite them.
- Attack is defined as a dog acting with force or harmfully resulting in physical injury such as bruising, puncture wounds or laceration.
- The majority of attacks reported to councils relate to attacks against animals.

Number of dogs impounded and returned to owner in South Australia**

	Impounded	Returned to Owner
2016-17	7688	4759
2015-16	8482	5165
2014-15	9374	6082
2013-14	10395	6895

*Statistical data for cats is not retained by many South Australian councils and therefore there is not comparative data to Playford.

**These figures and statistics are sourced from the Dog and Cat Management board 2016-17 Year in Review.

5. CITY OF PLAYFORD AND ANIMAL MANAGEMENT

The City of Playford is committed to providing high quality animal management practices and recognises the importance and health benefits of animals in people's lives.

Playford's Community Inspectors carry out a wide range of duties daily including animal management, fire prevention, parking inspection and litter control. Approximately 80% of a Community Inspector's time is utilised with animal management issues across our large and diverse council area. Issues range from stray dogs, dog attacks and harassments, nuisance cats and wandering stock.

The Regulatory Services Team provides a routine weekday, 9am-5pm service with an afterhours service providing a limited service from 7am-11pm 7 days a week.



5.1

ANIMAL WELFARE LEAGUE POUND/SHELTER

In 2003 it was recognised that the City of Playford needed a long term solution for impounding animals whilst at the same time providing good animal management practices and meeting the community's needs. This led to the development of a modern and well designed shared pound/shelter facility between City of Playford and the Animal Welfare League, (AWL), a not for profit organisation.

The pound/shelter facilities opened to the public in April 2005. Both City of Playford and AWL staff work together to achieve a high standard of animal management care and practices.

The pound is able to house dogs, cats and some livestock and fauna. A team of AWL staff are onsite 7 days a week to care for the animals and support Council's Community Inspectors to reunite pets with their owners.

The animals have access to clean comfortable enclosures, tailored diets, enrichment toys, exercise yards and lots of human interaction. The needs of puppies, kittens, pregnant, senior and sick animals are catered for. The facility also provides a 7 day reclaiming service for owners.



Since 2015 the AWL has expanded it's services at Edinburgh North.

AWL South Australia adopts animals from it's Wingfield facility, provides shelter to lost or unwanted domestic animals, community education programs and resources, discount microchipping events, pet care products and advice, a cremation service, boarding kennels and opportunities for volunteer work.



IN 2017 THE AWL EDINBURGH NORTH SHELTER REHOMED:



Source: Awl Edinburgh North - Outgoing Shelter Statistics
Featuring Only Animals Collected in the Playford Council Area.

6. CATS





6.1. CAT LEGISLATION

In 2016 the State Government introduced The Dog and Cat Management (Miscellaneous) Amendment Bill 2016 addressing community concerns about dog and cat welfare, overpopulation and nuisance behaviours.

Responsible ownership of cats has always been encouraged by Council. The changes to South Australia's laws include new requirements for microchipping and desexing of cats, as well as related expiation fees and fines for failing to comply with the new requirements. The changes are designed to increase the likelihood of lost or impounded cats being reunited with their owners and reduce the number of unwanted and abandoned litters euthanased in pounds and shelters.

From 1 July 2018 it will be compulsory for;

All cats born after 1 July 2018 to be desexed, (some exemptions apply for registered breeders).

All cats to be microchipped;

- before they are sold
- before reaching 12 weeks of age
- within 28 days after the owner takes possession of the cat

This law applies to all cats, including those owned prior to 1 July 2018.

Microchipping is a safe and permanent way to identify your cat. Council, in conjunction with other organisations, such as the AWL, will promote and offer discount microchipping days at various times.

Community Inspectors will be responsible for assisting owners to meet the new requirements, primarily by educating the community but also by administering the legislated penalties when necessary.

6.2.

CAT BY-LAW AND PERMITS

Council's By-law No 5 – Cats, was revised, made and passed at a meeting of the Council of the City of Playford on September 22nd 2015. Playford's Cat By-law allows Council to take action against those creating a nuisance by keeping excessive numbers of cats. It limits the number of cats to two per property and allows for conditional approval to exceed that limit. Applications for a permit to keep additional cats can be made in writing to the Regulatory Services Department of Council.

A copy of the By-law can be accessed on the City of Playford website.

playford.sa.gov.au/bylaws

6.3.

CATTERIES

The keeping of domestic animals for commercial purposes may require a development application to Council. Members of the public are encouraged to contact the Planning department of Council to enquire about whether their circumstances require an application for Planning consent.

During the process consultation may be required with other City of Playford departments such as the Health and Regulatory Services Team to identify issues and recommend conditions that may be applied in relation to the keeping of the animals. Approval of the application may as a result be subject to conditions determined by Council or an exemption permit may be issued under Council's Cat Bylaw.

In the event of concerns relating to insanitary conditions Playford's Environmental Health Team may investigate and take appropriate action under the Public Health Act 2011.

6.4.

CAT NUISANCE

Compared to dogs, City of Playford receives significantly fewer complaints in relation to cats; From July 2016 to June 2017 cat complaints logged to the Customer Request System totalled 81.

Complaints arise when cats cause a public nuisance by soiling, damaging property, fighting, killing wildlife and generally being where they are not wanted.

A stray and unowned cat population exists in significant numbers in the community and is the primary source of nuisance.

Education is a high priority in relation to cat management within the City of Playford. Council provides resources, links and information online to enable cat owners to enjoy cat ownership and optimise their cat's welfare and health while minimising potential nuisance to neighbours and the environment.

Residents experiencing problems with cats are advised not to feed or encourage strays but ask neighbours if they own the cat. The Dog and Cat Management Act 1995 provides for the seizure of unidentified cats by any person provided that, within 12 hours, they take it to a facility nominated by Council and approved by the Board. Council uses and asks residents to take unidentified cats to the Animal Welfare League Edinburgh North Shelter.



The City of Playford has an agreement with the AWL which allows residents to take stray and unwanted cats wandering on to their property free of charge to the AWL. AWL hires cat traps for a small fee and Council incurs the cost of handing cats over to AWL. Any trapped cats wearing identification must be released immediately.

The vast majority of cats impounded at AWL are classified as stray cats and are not reclaimed by owners. Between July 2016 and June 2017 of the 1342 stray cats and kittens impounded at AWL, 36 were reclaimed by owners.

Some cats which are strays and may have been abandoned by their owners are able to be rehoused through the AWL. They are desexed, microchipped and vaccinated before joining their happy new home. City of Playford supports and promotes the animal adoption service at the AWL.

Additional information for cat owners and the community can be found on the goodcatsa.com website.

7. DOGS



7.1. DOG BY-LAW AND PERMITS

The City of Playford By-Law 4 – Dogs, limits the number of dogs to two per premises, sets specifications for kennel establishments and provides for control of dogs on local government land. A copy of the By-law can be accessed on the City of Playford website;

By-Law No. 4 - Dogs.pdf

Dog owners wishing to keep more than two dogs per premises are required to apply for a permit from Council. Where an application meets the purpose of the By-law a Community Inspector will review the application, inspect the property and conduct any necessary investigations to assess the application. Permits require owners to comply with a number of conditions which are designed to minimise nuisance to neighbours and maintain compliance with relevant legislation.

The By-law also sets out areas on local government land, which may be classed as Dog Free, Dogs On Leash and Dog Exercise Areas.

Dog Free areas prohibit the presence of dogs unless the dog is an Assistance Dog.

Dogs On Leash areas require a dog to be secured by a leash no longer than two metres in length. These areas include;

- any park or reserve during times when organised sport is being played;
- within 5 metres of children's playground equipment;
- any wetland area;
- any local government land or public place that the Council determines to be an On Leash area.

Dog Exercise areas are identified by Council for the purpose of off leash exercise and require owners to maintain effective control of their dog by other means if off lead, while on that land.

7.1.2. KENNELS

The keeping of domestic animals for commercial purposes may require a development application to Council. Public consultation may be sought, taking into consideration any impacts which the proposed development may have beyond the boundaries of a property. Consideration is given to representations received under the public consultation process in determining the appropriateness of the application by Council prior to making a decision.

During the process consultation may be required with other City of Playford departments such as the Health and Regulatory Services Team to identify issues and recommend conditions that may be applied in relation to the keeping of the animals. Approval of the application may as a result be subject to conditions determined by Council or a dog Bylaw exemption permit may be issued by Regulatory Services.

Should kennels be erected you may need to apply for building and planning approval. It is best to call or email plan@playford.sa.gov.au to discuss a planning application before lodging with Council.

In the event of concerns relating to insanitary conditions Playford's Environmental Health Team may investigate and take appropriate action under the *Public Health Act 2011*.

7.1.3. BREEDERS

If the breeding of dogs will take place from 1 July 2018 the breeder must be registered with the Dog and Cat Management Board.

For more details of the requirements for breeders visit dogsandcatsonline.com.au

7.1.4

DOG IMPOUNDMENT

Council's first concern is safety when a dog is found wandering and not under the control of its owner. Lost dogs are often frightened, not traffic smart and can react negatively to strangers, placing the dog and the safety of the general public at risk. Community Inspectors will impound a dog whose owners cannot be found. This way Council can ensure that they are safely contained and cared for until their owners can claim them.

Dogs wearing their registration discs and with up to date microchip contact details, have the best chance of finding their owners quickly without needing to be impounded.

Council takes reports of lost dogs during business hours and as part of its' after hours service. Members of the public who find a dog must notify Council immediately so that every attempt to reunite the dog with its owner can be made.

Under the Dog and Cat Management Act 1995 there are clear legislative requirements regarding the impounding of dogs and the disposal of impounded dogs.

Dogs may be impounded if they are wandering at large, are deemed unduly dangerous or to prevent them from attacking, harassing or chasing a person, animal or bird. The Council may seize and detain a dog if it is in contravention of a Dog Control Order, a Prohibition Order exists, or for the purpose of carrying out a Destruction Order.

Councils are required under the Dog & Cat Management Act 1995 to hold impounded dogs for a minimum of 72 hours from the posting of the Notice of Detention.

Council's pound facilities are housed within the Animal Welfare League at Edinburgh North. A team of compassionate and qualified animal carers look after the dogs until their owners can be found. The dogs are housed in large, clean and sanitised pens with lots of warm bedding, heat lamps, toys, meals and treats. Exercise yards are available and veterinary care is provided if needed. The Animal

Welfare League also offers a public viewing portal for owners who have lost their dog to view.

Impoundment fees apply for dogs and penalties or fines may be issued to dog owners.

After the 72 hour time period has elapsed unclaimed dogs are transferred to the Animal Welfare League Shelter. Dogs are health and temperament tested for suitability for rehoming into the community. All dogs suitable for rehoming are vaccinated, microchipped and desexed before being put up for adoption by the Animal Welfare League Shelter.

7.1.5

DOG REGISTRATION AND FEES

It is compulsory for dogs to be registered once they reach three months of age or are of adult age residing on a property for more than two weeks.

The identification and registration of dogs is encouraged to assist;

- In the safe return of wandering dogs to their owners.
- Determining ownership of a dog in an emergency, in a dispute or for any legal purposes in which an owner wants to be recognised.

The Regulatory Services Team is responsible for administering the registration of dogs and the distribution of educational materials and registration renewals. All income from dog registration received by City of Playford is expended in the administration and enforcement of the provisions of the Dog and Cat Management Act relating to dogs. Monies are also expended on public safety initiatives, educational materials, related community events and recreational opportunities associated with dog ownership.

In 2017 two categories were introduced for dog registrations, Standard and Non-Standard Dog. These categories were introduced by changes in the Act designed to streamline dog registrations throughout the state.

Councils are responsible for setting dog registration fees and rebates within a recommended range.

To maximise dog registrations, City of Playford will provide incentives such as rebates for training, free first year registration for dogs purchased from the Animal Welfare League etc. Education campaigns, online promotions and enforcement through door knock programs will also contribute to reaching maximum dog registrations.

7.2. COMMUNITY EDUCATION

The Dog and Cat Management Board promotes a combination of education, encouragement and enforcement as a successful method of animal management. The Board's multimedia education campaign introducing the changes to dog and cat laws supports Council's ongoing efforts to bring awareness to the community.

Council's Regulatory Services and Marketing Teams will develop and carry out educational initiatives throughout the term of this Plan. At times this will involve engaging with other relevant stakeholders such as the AWL and the Board to promote and recognise responsible pet ownership and compliance. Council will focus on enjoyment of pets, pet events and recreational facilities in the community as well as awareness of and compliance with the law.

Council will develop media and online campaigns, brochures, events and educational initiatives to promote key issues.

Dog owners are encouraged to join community based dog obedience clubs to teach their dogs to be sociable, obedient and exercised. City of Playford supports obedience training through a registration rebate for a level 3 attainment.





7.3. ENFORCEMENT

The amendments to the Dog and Cat Management Act, which will be introduced over a period of 2 years, give local councils greater enforcement options. However, a number of these new amendments are a substantial change. The City of Playford will be mindful in its decision making. Action could range from education, enforcement, encouragement and open discussion with dog owners.

A number of offences for which an owner or person responsible for care and control of a dog are set out in the Dog and Cat Management Act. These include;

- Wandering at large.
- Attacking, harassing or chasing a person, animal or bird.
- Attacking a person lawfully entering premises.
- A dog, other than an Assistance Dog, being in or in the grounds of a school, kindergarten or child care centre without the permission of the person in charge of that place.
- Defecating in a public place, (unless the person with control of the dog immediately removes the faeces).
- Failure to register a dog with local council.

Members of the community who have witnessed or been involved in a possible offence should contact Council so that the matter can be investigated.

Fact sheets to help dog owners understand their responsibilities are available on the **gooddogs.com** website.

7.3.1.

EXCESSIVE BARKING

When dogs bark excessively it can interfere with the peace and comfort of those living in close proximity. The Regulatory Services Team deal with many allegations of nuisance barking each year.

Excessive barking allegations are processed in the following way;

- The person being aggrieved by the dog barking is required to fill out a dog barking diary to assist the investigating officer to determine the degree of annoyance experienced and any possible information that might assist the dog owner to abate the nuisance.
- If there is sufficient diary evidence the owner of the dog is approached and advised of the complaint. They are also given advice about the cause of any barking and suggested solutions.
- If there is a secondary complaint in relation to excessive barking a door knock of surrounding properties is undertaken to ascertain if the complaint is substantiated.
- If the complaint is substantiated there are a number of options available to Councils such as; warning notices, control orders, expiation notices, court imposed fines as well as prohibitions orders, etc.
- In 2017 changes to penalties for breaches of the Act in relation to nuisance dog barking came into effect. The Expiation Notice Fee and maximum penalty for Nuisance Barking increased and an expiation notice fee for Contravention of a Nuisance (Barking) Dog Order was introduced as well as an increase to the maximum penalty.
- The process for investigating barking complaints has been endorsed by the LGA, (Local Government Association), and is considered the Standard Operating Procedure across all SA councils.

7.3.2.

DOG ATTACK/HARASSMENT

Dog attacks or harassment are a major concern and take high priority at the City of Playford.

The Regulatory Services Team emphasis is on community safety, prevention and education as well as responding to incidents and prosecution of offences.

While the community enjoys the benefits of keeping dogs as pets, there will always be irresponsible owners and aggressive dogs.

Changes to the Act in 2017 allow for tougher penalties and greater powers for Councils' Authorised Officers to investigate and prosecute offences.

Dog attacks and harassment are dealt with in the following way;

- All reports of dog attack are attended to immediately.
- Harassment complaints are investigated within 24 hours during weekdays and the next working day on weekends and public holidays.
- Serious injury to a person or animal may result in a Destruction Order or a Control Order. Dog owners may be issued with expiation notices for offences or may be prosecuted.
- For offences of a lesser nature Council may issue a Control Order, expiation notices, advice to owners and recorded warnings.

7.4.

SOUTH AUSTRALIAN STANDARDS AND GUIDELINES FOR BREEDING AND TRADING COMPANION ANIMALS

The South Australian Standards and Guidelines for Breeding and Trading Companion Animals was introduced by the State Government in conjunction with the amendments to the Dog and Cat Management Act.

They are administered by the Animal Welfare Unit which is part of the Department of Environment and Water.

The Guidelines are not under the jurisdiction of the Dog and Cat Management Board however all breeders will be required to be registered with The Board from 1st July 2018. As this is part of the Act, Council will be responsible for enforcement.

7.5

DACO

From 1st July 2018 dog registration in South Australia was simplified with the introduction of a new web based system. The system allows owners to manage their pet dog or cat's microchip, health and breeder information.

Dogs And Cats Online, (DACO), is the central point for dog and cat management payments and information, replacing 68 individual council systems and private microchip databases. Dogs receive one lifetime dog registration number and disc.

DACO allows Council, vets and animal welfare agencies instant access to information from around the state so that lost dogs and cats may be quickly reunited with their owners.

The City of Playford was involved in consultations with the Board throughout the development of the site. Council will continue to work closely with the Board and other key partner organisations to implement DACO and to assist residents to optimise it's application.

dogsandcatsonline.com.au

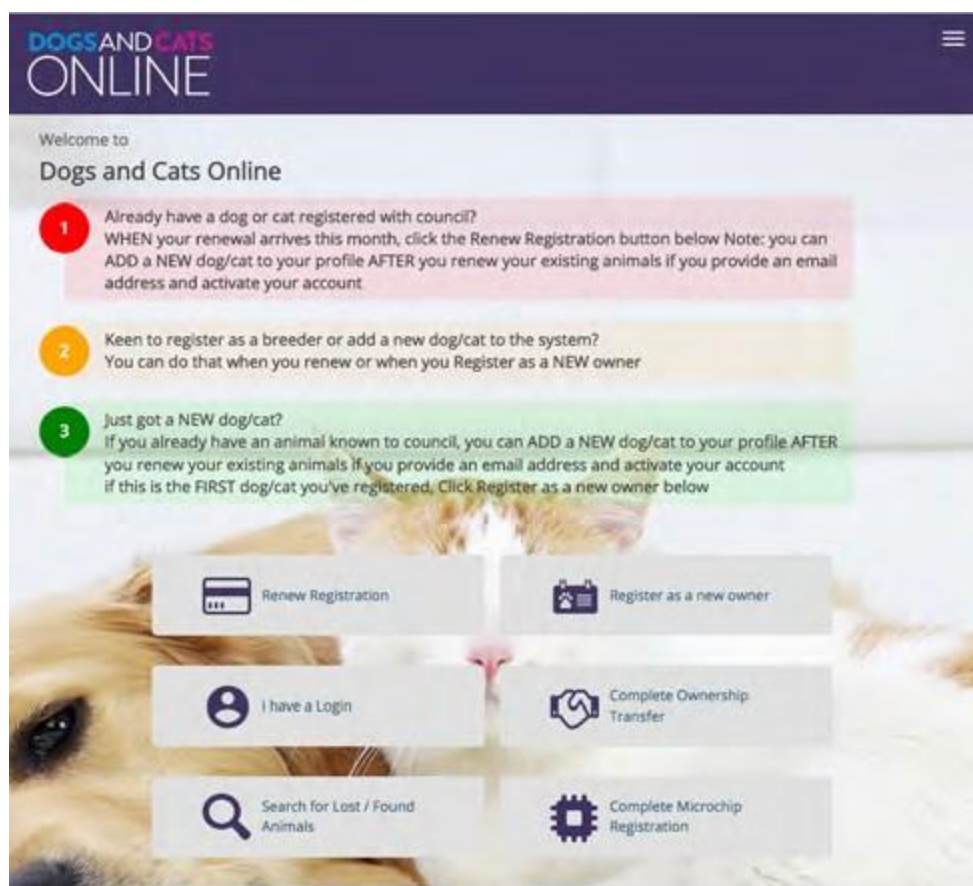

7.6.

OPEN SPACE

Exercise areas where dogs can be exercised or run freely play an important part in reducing problems associated with bored dogs such as barking. Dogs exercised in open space are less territorial and curious. Dogs and their owners can benefit from opportunities to socialise with others in a relaxed and safe environment.

The Dog and Cat Management Act 1995 requires dogs to be on a leash no longer than 2 metres in length whilst in all public places (a place to which the public has access). This includes places such as roads, footpaths, shopping centre car parks but does not include parks and reserves unless otherwise specified by Council's By-law.

Dog owners are reminded through education programs and enforcement that it is their responsibility to collect and properly dispose of their dog's faeces when using open space areas. Being a responsible owner will ensure that open space areas remain available for dog exercise and protect the environment. Through this Dog and Cat Management Plan budgetary consideration will be given to the installation of dog waste bins and signs in open space high traffic areas.

Parks, reserves and screening areas in Playford have been assessed from an analysis of the activities occurring in them to determine the likelihood of potential conflict with other users. These assessments determine an appropriate category for usage. Off-leash free running activity areas are given high priority for the general physical and social needs of dogs helping to avoid other behavioural problems.

Dog owners must have effective control of their dogs at all times and when off leash observe the following:

- Do not let the dog rush, worry, chase, threaten or bite any person or animal;
- Remain in effective voice or hand control of the dog so as to be able to promptly bring the dog under effective control by placing it on a leash no longer than two metres in length if that becomes necessary;
- Be mindful of the surrounding area and place and control the dog on a leash if the dog is in close proximity to a:
 - Sporting event;
 - Within 5 metres of children's play equipment;
 - Organised public activity, event or meeting;
 - Barbecue or dedicated picnic area.

Suggestions from the community regarding the adequacy of the off leash areas will be reviewed and analysed in terms of impacts on safety for the animal and potential for conflict with other users, and environmental impact.

All parks, reserves and screening areas within the City of Playford have been allocated with one or more the following four categories.

Future dog parks

Sites throughout the city are assessed as potential locations for dog parks as part of ongoing city development and more fenced dog parks will be installed within the time frame of this plan.

On Leash Areas

Identified on leash areas include wetland areas or areas of local government land or public places which the Council has resolved to be On Leash. Areas which are within 5 metres of a children's playground or during times when organised sport is being played on that area also require that dogs be secured by a strong leash, not exceeding two metres in length, which is either tethered securely to a fixed object or held by a person, capable of controlling the dog to prevent it from becoming a nuisance to other persons.

Dog Exercise Areas

Owners can allow their dogs to exercise off leash in these areas but must still keep their animal under effective control.

Dog Free Areas

A person must not allow a dog to be in or remain in one of these areas. Dog free areas have been categorised as such because they are heavily used for sporting activities, predominately playground area or because dogs would cause a safety issue or environmental damage. Assistance dogs are permitted in these areas.

7.7.

PLANNING FOR PETS

Urban growth in the future will impact on pet ownership with the size of backyards decreasing and smaller homes discouraging people from owning pets. It is often thought that dogs can only live happily in a large yard and it is a common misconception that dwelling type is important in successful pet ownership. Pets, in fact, can be successfully integrated into highly urbanised areas. Exercise and interaction with an owner is more beneficial (for both) than loneliness in a large backyard which leads to behavioural problems such as persistent barking.

Dogs also place greater demands on available public open space. For owners to be able to exercise their dogs regularly, access is needed to public areas within easy walking distance of home. In new residential areas there is scope to improve residents' ability to confine cats in the construction of new dwellings eg: internal courtyards, outdoor enclosures etc.

Good planning should integrate pets into urban environments, particularly with new residential housing, retirement developments, and recreational areas. The City of Playford's City Services Residential Development Team will consider integration of pets into urban environments, particularly with new residential housing, retirement developments and recreational areas through appropriate development policies and informed decision-making that considers the popularity, value and place of pets in society.



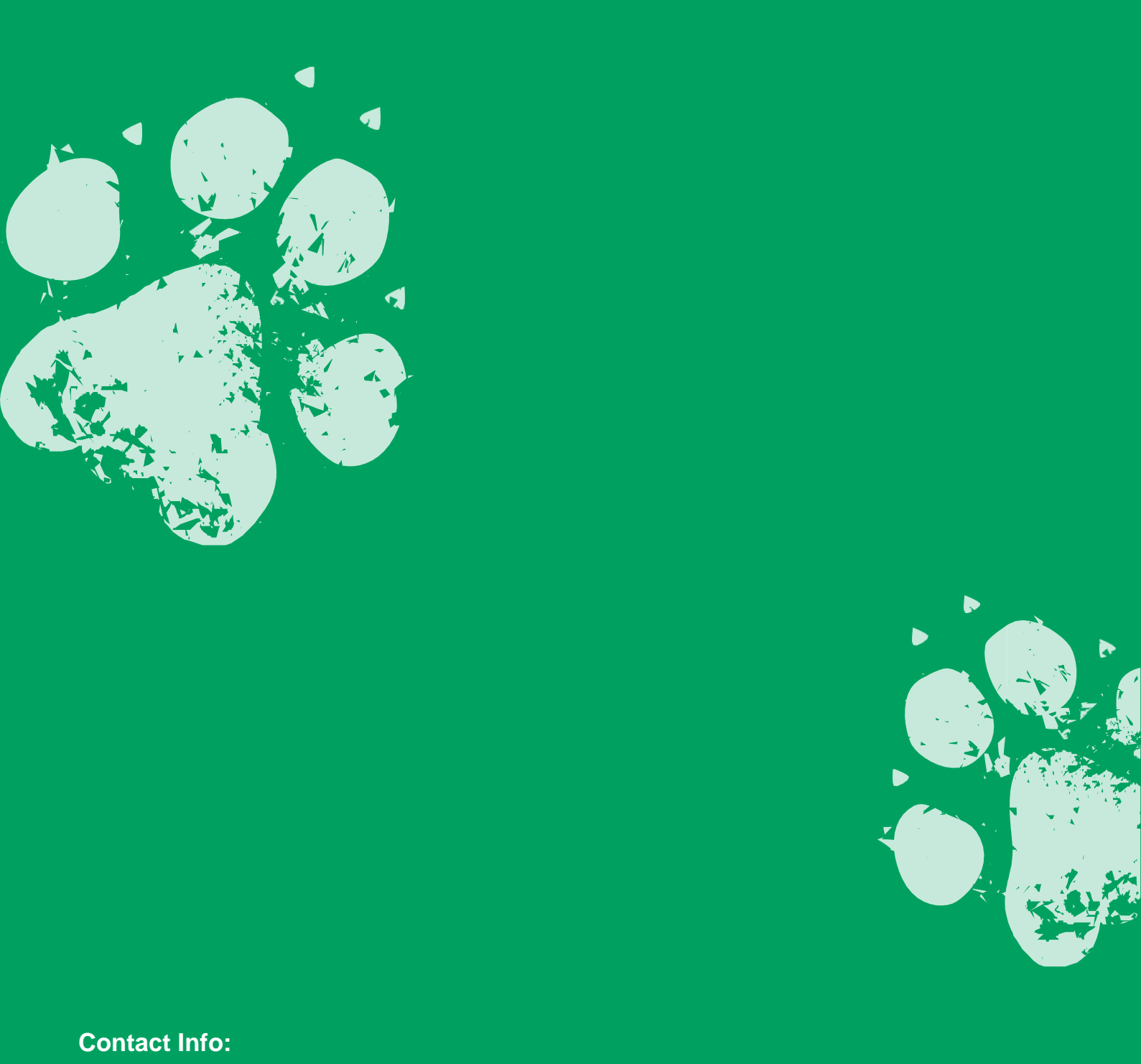

Contact Info:

CALL

(08) 8256 0333

VISIT

Playford Civic Centre
10 Playford Boulevard
Elizabeth SA 5112

Stretton Centre
307 Peachey Road
Munno Para SA 5115

POST

12 Bishopstone Road
Davoren Park SA 5113

EMAIL

playford@playford.sa.gov.au





DOG AND CAT MANAGEMENT PLAN

APPENDIX 1

ACTION PLAN



SMHERS: Senior Manager - Health, Environment & Regulatory Services
MRS: Manager Regulatory Services
SCI: Senior Community Inspector
CECO: Community Education and Compliance Officer
DCMB: Dog and Cat Management Board
AWL: Animal Welfare League SA

ACTION PLAN

OBJECTIVE 1.5.1.

Provide effective management and a suitable environment for dogs and cats within the community.

Strategy	Action	Time frame	Budget	Responsible Person	KPI's
1.5.1.a Support the Health and Safety of the Community Promote Community Information and Education Ensure effective Governance	Encourage and Promote the Registration of Dogs	Annually	Recurrent	SMHERS, MRS, SCI, CECO, Community Inspectors	Increase in registration rates. (Reduce number of unregistered dogs in the community).
	Annual Dog Registration Assessments to identify unregistered dogs and encourage registration	Annually	Recurrent	SMHERS, MRS, SCI, CECO, Community Inspectors	Decrease the amount of unregistered dogs each year to 10-20%
	Implement the use of DACO within Council and by the community.	Ongoing			Increase in registration rates and return to owner rates.
1.5.1.b Encourage education of dog and cat owners and non-pet owners. Make dog and cat owners aware of the changes to the Dog and Cat Management Act, i.e; mandatory	Develop initiatives to ensure that residents and visitors to the City of Playford understand the provisions and obligations under the Dog and Cat Management Act/relevant Legislation and participate in responsible pet ownership ie <ul style="list-style-type: none"> • Signage • Marketing programs • Publications • Targeted face to face education programs • Actively promote and share the DCMB facebook pages and website 	Ongoing	Recurrent	MRS, SCI, CECO, Community Inspectors	Information to be made available to the community via Customer Care Centres and Education Programs, Council website/ social media, Playford News Greater compliance to Dog and Cat Management Act Use of DACO by the community
	Develop collaborative approaches in conjunction with the Animal Welfare League in education programs, microchip days, publications and media campaigns in relation to responsible pet ownership and free first year registration for dogs purchased from the Animal Welfare League.	Ongoing	Recurrent	SMHERS, MRS, SCI, CECO, Community Inspectors	Increased registration of dogs that are microchipped Increased compliance with compulsory Microchipping legislation.
	Make available through City of Playford Customer Service Centres and website pamphlets and publications in relation to responsible pet ownership.	Ongoing	n/a	SCI	Greater compliance with the Dog and Cat Management Act

Strategy	Action	Time frame	Budget	Responsible Person	KPI's
1.5.1.b (cont) Encourage education of dog and cat owners and non-pet owners	Provide information in relation to animal management on the City of Playford Website and through various media formats such as rate notices, community news, Messenger, school newsletters, social media, Playford News, etc	Ongoing	n/a	SCI, CECO, Community Inspectors	
	Promote responsible animal management websites ie: gooddogs.com goodcats.com dogandcatboard.com.au animalwelfare.com.au rspcasa.asn.au	Ongoing	n/a	SCI, CECO, Community Inspectors	
1.5.1.c Maximise dog registration	Provide incentives for first time registration such as free first year registration for dogs purchased from the Animal Welfare League etc.	Ongoing	Recurrent	SMHERS, MRS	Increased Registration
	Promote the use of DACO by the community, staff are educated in how to use the site and will educate dog owners about the site.	Ongoing	Recurrent	SMHERS, MRS, SCI, CECO, Community Inspectors	Increased registration. Monitor DACO statistics.
	Provide and maintain on line and phone payment option as a convenient way for residents to register dogs	Ongoing	Recurrent	SMHERS, MRS, SCI, Marketing	Increased awareness via media i.e. council website
	Promote registration via social media competitions and campaigns.	Ongoing	Recurrent	SMHERS, MRS, SCI, CECO	Monitor entrant numbers/likes in social media competitions

Strategy	Action	Time frame	Budget	Responsible Person	KPI's
1.5.1.d Minimise dogs and cats wandering at large.	Educate owners of their responsibilities to contain their animals through: <ul style="list-style-type: none"> • Adequately securing and fencing their property • Keeping their animals under effective control when in a public place • Promote cat enclosures • Ensure dogs are leashed in public places 	Ongoing	Recurrent	SMHERS, MRS, SCI, CECO, Community Inspectors	Information to be developed and made available to the community via Customer Care Centres and Education Programs, Council website
	Community Inspectors will: <ul style="list-style-type: none"> • Conduct random patrols of public areas • Respond to calls of dogs wandering at large • Return identified wandering dogs and to owner as a priority • Unidentified dogs and cats wandering at large will be impounded in accordance with the Dog and Cat Management Act 1995 and the Impounding Act 1920. • Transfer unclaimed dogs and cats to Animal Welfare League Shelter where they are temperament tested and veterinary assessed. Dogs and cats suitable for rehoming will be desexed, immunised and microchipped. Animal Welfare League will notify City of Playford of the details of dogs and cats rehoused. • Warnings may be issued to first offences of a minor nature where no harm to person or property has occurred Penalties prescribed by the Dog and Cat Management Act will be applied for re-offenders. 	Ongoing	Recurrent	SMHERS, SCI, CECO, Community Inspectors	Greater compliance to Dog and Cat Management Act, Impounding Act, Decrease number of impounded dogs at the AWL

SMHERS: Manager Health and Regulatory Services
 MRS: Manager Regulatory Services
 SCI: Senior Community Inspector
 CECO: Community Education and Compliance Officer
 DCMB: Dog and Cat Management Board
 AWL: Animal Welfare League SA

Strategy	Action	Time frame	Budget	Responsible Person	KPI's
1.5.1.e Promote identification of animals.	Promote, educate and enforce the compulsory microchipping provisions of the Act. Promote discount microchipping events.	Ongoing	Recurrent	SMHERS, MRS, SCI, CECO, Community Inspectors	Greater compliance to Dog and Cat Management Act, Impounding Act
	Educate the community on the appropriate identification of dogs and cats ie: current registration disc for dogs, collar with address and phone number for cats	Ongoing	Recurrent	SCI, CECO, Community Inspectors	Monitor use of DACO by Playford residents. Decreased rates of impoundment.
	Undertake microchipping days in conjunction with the Animal Welfare League	Ongoing	Recurrent	SCI, CECO, Community Inspectors, AWL	Subsidised Microchipping for all cats, increase numbers on previous session
	Promote the use of DACO and Central Animal Records to keep microchip details current.	Ongoing	Recurrent	SCI, CECO, Community Inspectors	Monitor use of DACO by Playford residents. Decreased rates of impoundment.
1.5.1.f Report all dog attacks.	Register all dog attacks on the Dog and Cat Management Board database.	Ongoing	Recurrent	SMHERS, MRS, SCI, Community Inspectors DCMB	Monitor Database
	Encourage the community to report attacks/harassments.	Ongoing	Recurrent	SMHERS, MRS, SCI, CECO, Community Inspectors DCMB	Public Awareness
1.5.1.g Identify suitable dog on/off leash and dog park activity areas	Identify and update Dog On Leash, Off Leash, Dog Park and Dog Free activity areas through the City of Playford website.	Ongoing	Recurrent	SCI	Public Awareness
	Notify the Dog & Cat Management Board of Dog On Leash, Off leash, Dog Park and Dog Free areas.	Ongoing	Recurrent	SCI	
	Identify Dog On Leash, Off Leash, Dog Park, and Dog Free areas with appropriate signage (170 signs, post, spike & labour)	Ongoing	\$130,000 Project	Social Planning	Greater amount of dogs exercised, monitor use.

Strategy	Action	Time frame	Budget	Responsible Person	KPI's
1.5.1.g (cont) Identify suitable dog on/off leash and dog park activity areas	Identify Dog On Leash, Off Leash, Dog Park, and Dog Free areas with appropriate signage (170 signs, post, spike & labour)	Ongoing	Recurrent	SMHERS, MRS, City Operations	Greater compliance to Dog and Cat Management Act,
	Identify the concerns of non-pet owners concerning the use of open space by themselves and pet owners.	Ongoing	Recurrent	SMHERS, MRS, SCI, Community Inspectors	Monitor Compliance through regular park patrols
1.5.1.h Maximise the understanding of City of Playford's role in Animal Management	Use opportunities to raise awareness through <ul style="list-style-type: none"> • media opportunities • website, Playford News and social media • community events • displays • publications 	Ongoing	Recurrent	SMHERS, MRS, SCI, CECO, Community Inspectors	Monitor Website traffic Attendance at events
1.5.1.i Limit the number of dogs and cats per dwelling.	Enforce City of Playford <i>By-Law 4 – Dogs & By-Law 5 - Cats</i> and by law exemption application process.	Ongoing	Recurrent	SMHERS, MRS, SCI, CECO, Community Inspectors	Increase number of exemption permits issued
1.5.1. j Maintain and analyse animal management data to ensure animal management community needs are being addressed.	Acquire statistical information from the Pathway system modules: <ul style="list-style-type: none"> • Animal Management • Customer Request System • Receipting • After hours service 	Ongoing	Recurrent	MRS	Information is developed and passed on to the relevant stake holders
1.5.1.k Plan for the effective integration of pets into existing and new development	Incorporate pet keeping requirements into building and open space design.	Ongoing	Recurrent	Planning	Monitor registrations in new developments via reporting mechanism

OBJECTIVE 1.5.2.

Encourage responsible dog and cat ownership.

Strategy	Action	Time frame	Budget	Responsible Person	KPI's
1.5.2.a Provide education material to residents and visitors to the City of Playford.	Develop initiatives to ensure that residents and visitors to the City of Playford understand the provisions and obligations under the Dog and Cat Management Act/relevant Legislation and participate in responsible pet ownership ie: <ul style="list-style-type: none"> Media release Social media and Council website Playford News Publications Signage Brochures 	Ongoing	Recurrent	SMHERS, MRS, SCI, CECO, Community Inspectors	Information to be developed and made available to the community via Customer Care Centres and Education Programs, Council website Greater compliance to Dog and Cat Management Act Increase in dog registration.
	Actively promote the DCMB website and Facebook pages by sharing on social media, etc.			CECO, Community Inspectors, Marketing	Greater compliance to Dog and Cat Management Act
	Develop collaborative approaches in conjunction with the Animal Welfare League in education programs, microchip days, publications and media campaigns in relation to responsible pet ownership.	Ongoing	Recurrent	SCI, CECO, Community Inspectors	Increase attendance at microchipping days Greater compliance to Dog and Cat Management Act
	Make available through City of Playford Customer Service Centres pamphlets and publications in relation to responsible pet ownership such as: <ul style="list-style-type: none"> Dog and Cat Management Board publications City of Playford publications Animal Welfare League publications 	Ongoing	Recurrent	SCI, CECO, Community Inspectors	Information to be developed and made available to the community via Customer Care Centre and Council's website.
	Provide information in relation to animal management on the City of Playford Website and through various media formats such as rate notices, Playford News, Northern Messenger, school newsletters etc.	Ongoing	Recurrent	SCI	Monitor Website traffic Conduct regular Surveys

Strategy	Action	Time frame	Budget	Responsible Person	KPI's
1.5.2.a (cont) Provide education material to residents and visitors to the City of Playford.	Promote responsible animal management websites i.e. gooddogs.com goodcats.com dogandcatboard.com.au animalwelfare.com.au rspcasa.asn.au	Ongoing	Recurrent	SCI, CECO, Community Inspectors, Marketing	Greater compliance to Dog and Cat Management Act
1.5.2.b Enforce the provisions of the Dog and Cat Management Act.	Conduct random patrols of public areas	Ongoing	Recurrent	SCI, Community Inspectors	Greater compliance to Dog and Cat Management Act
	Impound unidentified dogs wandering at large in accordance with the Dog and Cat Management Act 1995.	Ongoing	Recurrent	SCI, Community Inspectors	Increase in dog registration
	Impound unidentified cats in accordance with the Dog and Cat Management Act 1995.	Ongoing	Recurrent	SCI, Community Inspectors	Decrease in the number of cats impounded
	Warnings may be issued for offences of a minor nature where no harm to person or property has occurred.	Ongoing	Recurrent	SCI, Community Inspectors	
	Enforcement action prescribed by the Dog and Cat Management Act will be undertaken	Ongoing	Recurrent	SCI, Community Inspectors	Budget
1.5.2.c Invite regular input regarding dog and cat management issues from interested groups throughout the community.	Develop collaborative approaches to responsible animal management education in conjunction with the Animal Welfare League, neighbouring councils, RSPCA and interested groups through various mediums	Ongoing	Recurrent	SMHERS, MRS, SCI	Increase in the amount of dogs trained
	Provide residents with the opportunity to comment on animal management through the City of Playford Customer Satisfaction Survey	Bi-annual	Project	SMHERS, MRS	Analyse survey results and act accordingly

OBJECTIVE 1.5.3.

Reduce public and environmental nuisance caused by dogs, cats and other animals.

Strategy	Action	Time frame	Budget	Responsible Person	KPI's
1.5.3.a Reduce the detrimental impact of dogs i.e. <ul style="list-style-type: none"> barking dogs, dog attacks or harassment, dog faeces in public places 	Develop and assess annually standard operating procedures to deal with barking dogs, dog attacks/harassment, and dog faeces.	Ongoing	Recurrent	SCI, Community Inspectors	Reduce amount of time to investigate complaints
	Investigate dog noise complaints in line with standard operating procedure.	Ongoing	Recurrent	SCI, Community Inspectors	Reduce the number of noise complaints
	Provide educational material and undertake referral to other agencies in relation to responsible dog ownership.	Ongoing	\$2,000	SCI, CECO, Community Inspectors	Information to be made available to the community via Customer Care Centres and Education Programs, Council website/social media
	Investigate all dog attacks/harassment complaints in line with standard operating procedure.	Ongoing	Recurrent	SCI, Community Inspectors	Reduce the number of attacks and harassments
	Promote the cleanup of dog faeces by owners through education, providing dog tidy bags, signage and enforcement	Project	\$4,000	SCI, Community Inspectors	Reduce the number of offenders
	Provide dog pound facilities for unwanted animals.	Ongoing	Recurrent	SCI, Community Inspectors	Number of dogs and cats impounded annually
	Enforce City of Playford By-Law 4 – Dogs and the Bylaw exemption permit application process.				



Strategy	Action	Time frame	Budget	Responsible Person	KPI's
1.5.3.b Reduce the detrimental impact of cats i.e. <ul style="list-style-type: none"> • nuisance caused by cats • cat faeces in public places • destruction of wildlife 	Develop and assess annually standard operating procedures to deal with cat nuisance	Ongoing	Recurrent	SCI	Reduce the number of complaints for nuisance cats
	Provide residents with access to cat cages, (customer cage hire administered by AWL)	Ongoing	Recurrent	SCI, Community Inspectors	Reduce the number of complaints for nuisance cats
	Provide cat pound facilities for unwanted animals.	Ongoing	Recurrent	SMHERS, MRS	Number of impounded Cats
	Provide educational material and undertake referral to other agencies in relation to responsible cat ownership.	Ongoing	Recurrent	SCI, CECO, Community Inspectors, DCMB, AWL	Information to be made available to the community via Customer Care Centres and Education Programs, Council website/social media
	Provide information on building cat enclosures and promote indoor cat living, promote DCMB, goodcatsa.com	Project	Recurrent		
	Enforce City of Playford By-Law 5 – Cats.			SCI, CECO,	Increase the de-sexing rate (up to from vets and



OBJECTIVE 1.5.4.

Provide for the welfare and safety of dogs and cats.

Strategy	Action	Time frame	Budget	Responsible Person	KPI's
1.5.4.a Identified wandering/ impounded dogs & cats are to be returned to their owners as soon as practical.	Develop and assess annually standard operating procedures to deal with wandering/ impounded dogs.	Ongoing	Recurrent	SCI	Reduce the number of Dogs Wandering at Large
	Promote the identification of dogs and cats.	Ongoing	Recurrent	SCI, CECO, Community Inspectors	Increase the number of dogs returned to owners
	Maintain data information of microchipped dogs.	Ongoing	Recurrent	SCI, CECO	Through technology
	Make available 7 days a week access to pound facilities.	Ongoing	Recurrent	SCI, AWL	
	Provide 24 hour collection of wandering dogs.	Ongoing	Recurrent	SCI, Community Inspectors	After hour service
	Maintain lost and found register	Ongoing	Recurrent	SCI, Community Inspectors	
1.5.4.b Impounded dogs and cats have clean safe facilities	Ensure the dog and cat pound facilities are in accordance with the Guideline for the Management of Dogs and Cats in Council Facilities (management), (welfare) 2013	Ongoing	Recurrent	SMHERS, MRS, SCI, AWL	DCMB Audit, measure against RSPCA pound guidelines
	Conduct regular audit of pound for compliance.	Annually	Recurrent	SMHERS, MRS, SCI, DCMB, AWL	

SMHERS: Manager Health and Regulatory Services

MRS: Manager Regulatory Services

SCI: Senior Community Inspector

CECO: Community Education and Compliance Officer

DCMB: Dog and Cat Management Board

AWL: Animal Welfare League SA

OBJECTIVE 1.5.5.

Acknowledge the importance of dogs and cats in society.

Strategy	Action	Time frame	Budget	Responsible Person	KPI's
1.5.5.a Provide up to date information regarding the benefits of responsible dog and cat ownership.	Promote the benefits to the community of responsible pet ownership through educational materials	Ongoing	Recurrent	SCI, CECO, Community Inspectors, DCMB	Greater compliance to Dog and Cat Management Act
		Ongoing	Recurrent	SCI, CECO, Community Inspectors	
	Encourage membership to local dog obedience clubs.	Ongoing	Recurrent	SCI, CECO, Community Inspectors	Increase registration for trained dogs

OBJECTIVE 1.5.6.

Minimise Public Risk.

Strategy	Action	Time frame	Budget	Responsible Person	KPI's
1.5.6.a Conduct regular patrols of City of Playford.	Develop a schedule to provide even distribution of staff resources across the city	Ongoing	Recurrent	SCI, Community Inspectors	Public Interaction and education
	Provide trained Authorised Officers to educate, mediate and enforce the provision of relevant Acts and legislation.	Ongoing	Recurrent	SCI, CECO, Community Inspectors	
	Encourage the community to report breaches of legislation to enable the speedy resolution of issues and provide for proactive animal management.	Ongoing	Recurrent	SCI, CECO, Community Inspectors	Public education programs, meetings and interaction

SMHERS: Manager Health and Regulatory Services

MRS: Manager Regulatory Services

SCI: Senior Community Inspector

CECO: Community Education and Compliance Officer

DCMB: Dog and Cat Management Board

AWL: Animal Welfare League SA

OBJECTIVE 1.5.7.

Protect native fauna and flora from the impact of dogs and cats.

Strategy	Action	Time frame	Budget	Responsible Person	KPI's
1.5.7.a Clearly define areas unsuitable for dog and cat recreation and exercise.	Provide information on parks within the City of Playford where: <ul style="list-style-type: none"> dogs may be exercised off leash parks where dogs must be under effective control by means of a physical restraint, parks where dogs are prohibited fenced dog parks 	Ongoing	Recurrent	SCI, CECO, Community Inspectors	Customer surveys
1.5.7. b Make available educational information on the detrimental effects of cats on native fauna	Provide educational material and undertake referral to other agencies in relation to responsible dog & cat ownership.	Ongoing	Recurrent	SCI, CECO, Community Inspectors	
	Provide information and advice on building cat enclosures and indoor cat living				

OBJECTIVE 1.5.8.

Expenditure of registration fees Expenditure of registration fees in the administration or enforcement of the provisions of the Dog and Cat Management Act 1995 relating to dogs.

Strategy	Action	Time frame	Budget	Responsible Person	KPI's
1.5.8.a Conduct regular reviews of income and expenditure to ensure best practice with available funds.	Maintain data bases that collect and ensure accurate information ie: <ul style="list-style-type: none"> Receipting Module Customer Request System Animal Management Module 	Ongoing	Recurrent	Customer Contact, MRS	Customer Contact internal processes
	Complete and provide annual reports to the Dog and Cat Management Board.	Annually	Recurrent	SCI	
	Undertake monthly reviews of Regulatory Services Budget.	Ongoing	Recurrent	MRS	Budget

OBJECTIVE 1.5.9.

Plan for integration of pets into urban environments.

Strategy	Action	Time frame	Budget	Responsible Person	KPI's
1.5.9.a Include integration of pets into urban environments, particularly with new residential housing, retirement developments and recreational areas through informed decision-making and planning that accounts for the popularity, value and place of pets in society.	Incorporate pet keeping requirements into building and open space design	Ongoing	Recurrent	Planning	Pet friendly concepts and provided to builders and developers
	Encourage developers to include animal/owners concerns in their development.	Ongoing	Recurrent	Planning	

SMHERS: Manager Health and Regulatory Services

MRS: Manager Regulatory Services

SCI: Senior Community Inspector

CECO: Community Education and Compliance Officer

DCMB: Dog and Cat Management Board

AWL: Animal Welfare League SA



DOG AND CAT MANAGEMENT PLAN

APPENDIX 2

ON / OFF LEASH AREAS



BY-LAW NO. 4 – DOGS – IDENTIFICATION OF DOG FREE AREAS, DOG ON LEASH AREAS AND DOG EXERCISE AREAS

Note: For the purpose of this identification process, “Dog Exercise Areas” are “Dog On Leash”, “Dog Off Leash” and “Established Dog Park” areas as indicated in the table below.

RESERVE NUMBER	RESERVE	ADDRESS	FUTURE DOG PARK	ESTABLISHED DOGPARK	ONLEASH	OFFLEASH	DOGFREE AREAS
	ANDREWS FARM						
1	Andrews Park, Andrews Farm	Commodore Parade, ANDREWS FARM Roseworthy Drive, ANDREWS FARM Carabeen Crescent, ANDREWS FARM			•		
2	Borden Reserve, Andrews Farm	Bordan Court, ANDREWS FARM				•	
3	Clansman Ave Reserve, Andrews Farm	Grace Avenue, ANDREWS FARM				•	
4	Crawford Grove Linear Reserve	Crawford Grove, ANDREWS FARM				•	
5	Crittenden Reserve, Andrews Farm	Grace Avenue, ANDREWS FARM				•	
6	Crittenden Road Reserve, Andrews Farm	Stebonheath Road, ANDREWS FARM				•	
7	Davoren Road Screening Reserve	Davoren Road, ANDREWS FARM President Avenue, ANDREWS FARM Stebonheath Road, ANDREWS FARM				•	
8	Davoren Road Windbreak	Prosperity Way, ANDREWS FARM			•		
9	Dawn Close Local Park	Dawn Close, ANDREWS FARM			•		
10	Earl Court Linear Park	Ensign Court, ANDREWS FARM				•	
11	Finch Close Park	Finch Close, ANDREWS FARM				•	
12	Flannery Reserve	Flannery Crescent, ANDREWS FARM			•	•	
13	Grace Reserve, Andrews Farm	Grace Avenue, ANDREWS FARM				•	
14	Greenfield Linear	Greenfields Drive, ANDREWS FARM				•	
15	Greenfields Drive Screening Reserve	Greenfields Drive, ANDREWS FARM				•	
16	Greenfields Reserves, Andrews Farm	Leicester Grove, ANDREWS FARM Greenfields Drive, ANDREWS FARM				•	
17	Hillier Screening Reserve, Andrews Farm	Bredford Grove, ANDREWS FARM				•	
18	Hughes Reserve, Andrews Farm	Hughes Street, ANDREWS FARM Leicester Grove, ANDREWS FARM				•	

19	Leicester Grove Dryland Reserve	Leicester Grove,ANDREWS FARM				•	
20	Mayfair Ride Safe Park	Concord Way, ANDREWS FARM			•		
21	Mendota Reserve, Andrews Farm	Mendota Avenue, ANDREWS FARM			•	•	
22	Millikan Reserve, Andrews Farm	Millikan Court, ANDREWS FARM				•	
23	President Avenue, Andrews Farm	President Avenue, ANDREWS FARM				•	
24	Riesling Crescent, Andrews Farm	Riesling Crescent, ANDREWS FARM Coonawarra Crescent, ANDREWS FARM				•	
25	Roseworthy Reserve, Andrews Farm	Carabeen Crescent, ANDREWS FARM			•	•	
26	Sharrad Court/Andrews Road Walkway	Sharrad Court, ANDREWS FARM			•		
27	St Columba Oval, Andrews Farm	Leicester Grove, ANDREWS FARM			•		
28	Stebonheath Park, Andrews Farm	Crittenden Road, SMITHFIELD PLAINS President Avenue, ANDREWS FARM President Avenue, ANDREWS FARM				•	
29	Stebonheath Dog Park, Andrews Farm	Davoren Road, ANDREWS FARM		•			
30	Stebonheath Road Screening Reserve	Stebonheath Road, ANDREWS FARM Grace Avenue, ANDREWS FARM Bredford Grove, ANDREWS FARM				•	
31	Trinity Court Drainage Reserve	Trinity Court, Munno Para				•	
32	West Parkway Reserve, Andrews Farm	West Parkway, ANDREWS FARM			•	•	

RESERVE NUMBER	RESERVE	ADDRESS	FUTUREDOG PARK	ESTABLISHED DOGPARK	ONLEASH	OFFLEASH	DOGFREE AREAS
	ANGLE VALE						
33	AM Dawkins Reserve, Angle Vale	Heaslip Road, ANGLE VALE			•		
34	Angle Vale Community Oval	Fradd Road, ANGLE VALE			•		
35	Broster Drainage Reserve	Elm Drive, ANGLE VALE				•	
36	Cabernet Reserve, Angle Vale	Cabernet Court, ANGLE VALE			•		
37	Chardonnay Reserve, Angle Vale	Chardonnay Court, ANGLE VALE			•	•	
38	Edmonds Reserve, Angle Vale	Edmonds Road, ANGLE VALE				•	
39	Harradine Court Drainage Reserve	Fradd Court, ANGLE VALE			•		

40	Heaslip Road Screening Reserve	Heaslip Road, ANGLE VALE			•		
41	Lorenzo Court Drainage Reserve	Lorenzo Court, ANGLE VALE			•		
42	Riverbanks Road Open Space, Angle Vale	Riverbanks Road, ANGLE VALE			•		
43	Strangways Reserve, Angle Vale	Strangways Road, ANGLE VALE				•	
44	Trinity Way Drainage Reserve	Heaslip Road, ANGLE VALE			•		

RESERVE NUMBER	RESERVE	ADDRESS	FUTURE DOG PARK	ESTABLISHED DOG PARK	ON LEASH	OFF LEASH	DOG FREE AREAS
	BIBARINGA						
45	Eagles Nest Drive Water Reserve	Eagles Nest Drive, BIBARINGA			•		
46	Open Space Reserve, Bibaringa	Alexander Avenue, BIBARINGA			•		

RESERVE NUMBER	RESERVE	ADDRESS	FUTURE DOG PARK	ESTABLISHED DOG PARK	ON LEASH	OFF LEASH	DOG FREE AREAS
	BLAKEVIEW						
47	Applecross Reserve, Blakeview	Park Lake Boulevard, BLAKEVIEW				•	
48	Applecross/Bentley Walkway	Applecross Drive, BLAKEVIEW				•	
49	Baron Road Local Park	Camelot Drive, BLAKEVIEW			•		
50	Cherrytree Reserve, Blakeview	Balmoral Circuit, BLAKEVIEW Cherrytree Crescent, BLAKEVIEW Main North Road, BLAKEVIEW				•	
51	Cowley Reserve, Blakeview	Smith Street, BLAKEVIEW				•	
52	Elmwood Walk, Blakeview	Elmwood Circuit, BLAKEVIEW				•	
53	Grandview Place Dryland Reserve	Grandiew Place, BLAKEVIEW				•	
54	Horrie Knight Reserve, Blakeview	Craigmore Road, BLAKEVIEW				•	
55	Kingate Boulevard Drainage Reserve	Craigmore Road, BLAKEVIEW			•		
56	Kevin Taylor Reserve, Blakeview	Uley Road, BLAKEVIEW			•		
57	Knightsbridge Estate Reserve, Blakeview	Fleetwood Drive, BLAKEVIEW Bishop Crescent, BLAKEVIEW				•	
58	Lynton Street/Smith Street Walkway	Smith Street, BLAKEVIEW			•		

59	Main North Road Screening Reserve	Main North Road, BLAKEVIEW				•	
60	Maplewood/Smith Street Walkway	Pinewood Avenue, BLAKEVIEW			•		
61	Newland Reserve, Blakeview	Newland Court, BLAKEVIEW				•	
62	Norman Terrace Watercourse	Craigmore Road, BLAKEVIEW				•	
63	Open Space Reserve	Smith Road, BLAKEVIEW					•

RESERVE NUMBER	RESERVE	ADDRESS	FUTURE DOG PARK	ESTABLISHED DOG PARK	ON LEASH	OFF LEASH	DOG FREE AREAS
	BLAKEVIEW						
64	Oxford Terrace Screening Reserve, Blakeview	Oxford Terrace, BLAKEVIEW			•	•	
65	Park Terrace Reserve, Blakeview	Park Terrace, BLAKEVIEW			•		
66	Park Lake Boulevard Drainage Reserve	Park Lake Boulevard, BLAKEVIEW			•		
67	Park Lake Boulevard Reserve, Blakeview	Park Lake Boulevard, BLAKEVIEW				•	
68	Park Lake Boulevard/Oxford Tce Linear Reserve	Oxford Terrace, BLAKEVIEW			•	•	
69	Pinewood Avenue/Andrews Road Walkway	Pinewood Avenue, BLAKEVIEW				•	
70	Pooch Park, Jabez Way	Jabez Way, BLAKEVIEW		•			
71	Blakes Crossing Adventure Park, Blakeview	Redwood Avenue, BLAKEVIEW			•		
72	Riverview Parade Screening Reserve	Park Lake Boulevard, BLAKEVIEW				•	
73	Springbank Grove Screening Reserve, Blakeview	Springbank Grove, BLAKEVIEW				•	
74	Springvale Reserve, Blakeview	Woodcroft Drive, BLAKEVIEW			•	•	
75	Smiths Creek Sanctuary, Blakeview	Sanctuary Walk, BLAKEVIEW Daintree Walk, BLAKEVIEW				•	
76	Toorak Drive Local Park	Toorak Drive, BLAKEVIEW				•	
77	Toorak/Applecross Walkway	Toorak Drive, BLAKEVIEW				•	
78	Uley Road Screening Reserve, Blakeview	Drage Street, ELIZABETH DOWNS Main North Road, BLAKEVIEW Uley Road, BLAKEVIEW				•	

RESERVE NUMBER	RESERVE	ADDRESS	FUTURE DOG PARK	ESTABLISHED DOG PARK	ON LEASH	OFF LEASH	DOG FREE AREAS
	BUCKLAND PARK						
79	Legoe Road Reserve, Buckland Park	Legoe Road, BUCKLAND PARK					•

RESERVE NUMBER	RESERVE	ADDRESS	FUTURE DOG PARK	ESTABLISHED DOG PARK	ON LEASH	OFF LEASH	DOG FREE AREAS
	CRAIGMORE						
80	Adams Creek, Craigmore	Gooronga Drive, CRAIGMORE Illawarra Court, CRAIGMORE Whitford Road, CRAIGMORE Indee Crescent, CRAIGMORE				•	
81	Adams Road Screening Reserve	Adams Road,CRAIGMORE				•	
82	Admella Walk	Blair Park Drive, CRAIGMORE			•	•	
83	Admella Walk, Craigmore	Browne Circuit, CRAIGMORE			•		
84	Alfred Close Reserve, Craigmore	Alfred Close, CRAIGMORE				•	
85	Axminster Crescent Reserve	Axminster Crescent, CRAIGMORE				•	
86	Baldina Reserve, Craigmore	Bundarra Court, CRAIGMORE				•	
87	Beatrix Reserve, Craigmore	Uley Road, CRAIGMORE				•	
88	Bentley Walk, Craigmore	Craigmore Road, CRAIGMORE Cardiff Court, CRAIGMORE Milan Court, CRAIGMORE				•	
89	Blackwood Reserve, Craigmore	California Avenue, CRAIGMORE				•	
90	Blair Park Drive Screening Reserve, Craigmore	Blair Park Drive, CRAIGMORE 195 Red Gum Court, CRAIGMORE Olinda Street, CRAIGMORE				•	
91	Bluebush Court Screening Reserve, Craigmore	Bluebush Court, CRAIGMORE				•	
92	Boronia/Uley Road Screening Reserve, Craigmore	Uley Road, CRAIGMORE Coolibah Avenu, CRAIGMORE			•		
93	Bundarra Walk, Craigmore	Adams Road, CRAIGMORE				•	
94	Bundarra Walk, Craigmore	Frith Road, CRAIGMORE			•		
95	California Reserve, Craigmore	California Avenue, CRAIGMORE			•	•	
96	Candlebark Reserve, Craigmore	Uley Road, CRAIGMORE				•	
97	Chilton Dryland Reserve	Yeovil Circuit, CRAIGMORE				•	
98	Chowilla Reserve, Craigmore	Adams Road, CRAIGMORE				•	

99	Conmurra Reserve, Craigmore	Coorara Court, CRAIGMORE				•	
100	Coorara Walk, Craigmore	Coorara Court, CRAIGMORE Blair Park Drive, CRAIGMORE Frith Road, CRAIGMORE				•	
101	Craigmore Park East, Craigmore	Red Gum Court, CRAIGMORE Uley Road, CRAIGMORE				•	
102	Craigmore Park North East Watercourse	Christine Avenue, CRAIGMORE				•	
103	Craigmore Park West, Craigmore	Adams Road, CRAIGMORE Blair Park Drive, CRAIGMORE Ironbark Avenue, CRAIGMORE Browne Circuit, CRAIGMORE				•	
104	Currawong Reserve, Craigmore	Chowilla Court, CRAIGMORE			•		
105	Dimboola Reserve, Craigmore	Currawong Crescent, CRAIGMORE Dimboola Court, CRAIGMORE				•	
106	Dublin Reserve, Craigmore	Craigmore Road, CRAIGMORE				•	
107	Enmore Reserve, Craigmore	Enmore Drive, CRAIGMORE				•	
108	Enmore Screening Reserve, Craigmore	Adams Road, CRAIGMORE				•	
109	Equestrian Reserve, Craigmore	Megunya Crescent, CRAIGMORE				•	
110	Equestrian Screening Reserve, Craigmore	Indee Crescent, CRAIGMORE				•	
111	Fergusson Bowl Drainage Reserve	Fergusson Bowl, CRAIGMORE				•	
112	Gapper Court Reserve, Craigmore	Mander Crescent, CRAIGMORE				•	
113	Gapper Reserve, Craigmore	Gapper Court, CRAIGMORE Mark Avenue, CRAIGMORE				•	
114	Gooronga Reserve, Craigmore	Karinga Avenue, CRAIGMORE				•	
115	Gunnawarra Walk, Craigmore	Gunnawarra Crescent, CRAIGMORE				•	
116	Ina Reserve, Craigmore	Gooronga Drive, CRAIGMORE				•	
117	Jasmine Court Reserve, Craigmore	Jasmine Court, CRAIGMORE Adams Road, CRAIGMORE				•	
118	Jedna Reserve, Craigmore	Gooronga Drive, CRAIGMORE				•	
119	Kakuna Walk, Craigmore	Kakuna Crescent, CRAIGMORE Turner Drive, CRAIGMORE				•	
120	Karinga Reserve, Craigmore	Karinga Avenue, CRAIGMORE Luscombe Way, CRAIGMORE Megunya Crescent, CRAIGMORE				•	
121	Karrawirra Walk, Craigmore	Karrawirra Close, CRAIGMORE Turner Drive, CRAIGMORE				•	
122	Lachlan Reserve, Craigmore	Indee Crescent, CRAIGMORE Lachlan Drive, CRAIGMORE				•	
123	Lomalinda Reserve, Craigmore	Kanimbla Cescent, CRAIGMORE				•	
124	Lomalinda Reserve, Craigmore	Lomalinda Drive, CRAIGMORE				•	

125	Mander Crescent Linear Reserve	Megunya Crescent, CRAIGMORE				•	
126	Manya Reserve, Craigmores	Lomalinda Drive, CRAIGMORE			•		
127	Marena Reserve, Craigmores	Marena Avenue, CRAIGMORE			•		
128	Megunya Reserve, Craigmores	Karinga Avenue, CRAIGMORE				•	
129	Meningie Reserve, Craigmores	Turner Drive, CRAIGMORE				•	
130	Mildera Reserve, Craigmores	Karinga Avenue, CRAIGMORE				•	
131	Nilpena Reserve, Craigmores	Tareena Street, CRAIGMORE				•	
132	Perre Reserve, Craigmores	Perre Drive, CRAIGMORE Nilpena Court, CRAIGMORE Yorktown Road, CRAIGMORE			•	•	
133	Pinda Reserve	214 Otama Court, CRAIGMORE				•	
134	Pinda Reserve, Craigmores	Tareena Street, CRAIGMORE				•	
135	Pinehurst Reserve, Craigmores	Uley Road, CRAIGMORE Pinehurst Court, CRAIGMORE				•	
136	Quantock Drainage Reserve	Quantock Crescent, CRAIGMORE				•	
137	Reginald Parade Screening Reserve	Reginald Parade, CRAIGMORE				•	
138	Reginald Parade Screening Reserve, Craigmores	Uley Road, CRAIGMORE 406 Adams Road, CRAIGMORE				•	
139	Rome Reserve, Craigmores	California Avenue, CRAIGMORE			•	•	
140	Solaprobe Close Dryland Reserve	Solaprobe Close, CRAIGMORE				•	
141	Somerset Grove Drainage Reserve	Somerset Grove, CRAIGMORE				•	
142	Tareena Reserve South, Craigmores	Vitana Court, CRAIGMORE				•	
143	Tareena Reserve, Craigmores	Tareena Street, CRAIGMORE			•	•	
144	Taunton Reserve, Craigmores	Taunton Crescent, CRAIGMORE Sedgemoor Road, CRAIGMORE			•	•	
145	Turner Drive/Kakuna Crescent Screening/Walkway Reserve	Kakuna Crescent, CRAIGMORE				•	
146	Turner Reserve, Craigmores	Turner Drive, CRAIGMORE				•	
147	Turner Screening Reserve	Marena Avenue, CRAIGMORE				•	
148	Turner Screening Reserve	Turner Drive, CRAIGMORE				•	
149	Turner Screening Reserve East, Craigmores	Turner Drive, CRAIGMORE				•	
150	Turner Screening Reserve West, Craigmores	Turner Drive, CRAIGMORE				•	
151	Turner Walk North, Craigmores	Manya Crescent, CRAIGMORE			•		
152	Turner Walk South, Craigmores	Turner Drive, CRAIGMORE				•	

153	Tone Court Screening Reserve, Craigmore	Tone Court, CRAIGMORE			•	•	
154	Uley Road Road Reserve	Uley Road, CRAIGMORE				•	
155	Vitana Reserve, Craigmore	Wanbi Court, CRAIGMORE				•	
156	Wanbi Reserve, Craigmore	Wanbi Court, CRAIGMORE				•	
157	Wanbi Walk, Craigmore	Blair Park Drive, CRAIGMORE			•		
158	Whitford Road Reserve, Craigmore	Alfred Close, CRAIGMORE				•	
159	Yorktown Screening Reserve, Craigmore	Adams Road, CRAIGMORE Lomalinda Drive, CRAIGMORE Yorktown Road, CRAIGMORE			•		

RESERVE NUMBER	RESERVE	ADDRESS	FUTURE DOG PARK	ESTABLISHED DOG PARK	ON LEASH	OFF LEASH	DOG FREE AREAS
	DAVOREN PARK						
160	Anne Wright Reserve, Davoren Park	Dowlish Street, DAVOREN PARK			•		
161	Arura Reserve, Davoren Park	Heytesbury Road, DAVOREN PARK	•		•	•	
162	Bishopstone Reserve, Davoren Park	Bishopstone Road, DAVOREN PARK				•	
163	Bishopstone Road Drainage Reserve	Bishopstone Road, DAVOREN PARK				•	
164	Chesterman Reserve, Davoren Park	Coventry Road, DAVOREN PARK Chesterman Street, DAVOREN PARK				•	
165	Forde Reserve, Davoren Park	Forde Street, DAVOREN PARK				•	
166	Heytesbury Reserve, Davoren Park	Heytesbury Road, DAVOREN PARK				•	
167	Kalara Reserve, Davoren Park	Peachey Road, DAVOREN PARK			•	•	
168	Mandeville/Longbridge Reserve, Davoren Park	Mandeville Street, DAVOREN PARK				•	
169	Pete Smith Reserve, Davoren Park	Charmouth Road, DAVOREN PARK				•	
170	Sandford Reserve, Davoren Park	Winkfield Street, DAVOREN PARK			•		
171	Stebonheath Drainage Reserve, Davoren Park	Fordingbridge Road, DAVOREN PARK Gores Road, DAVOREN PARK Stapleton Street, DAVOREN PARK Stebonheath Road, DAVOREN PARK				•	
172	Webster Reserve, Davoren Park	Webster Street, DAVOREN PARK			•		
173	Whittington Road Screening Reserve	Stebonheath Road, DAVOREN PARK				•	
174	O’Brien Reserve, Davoren Park	O’Brien Street, DAVOREN PARK			•		
175	Womma Road Screening Reserve, Davoren Park	Womma Road, DAVOREN PARK				•	
176	Womma Road Windbreak	Womma Road, DAVOREN PARK				•	

177	Woodcutts Road Drainage Reserve, Davoren Park	Woodcutts Road, DAVOREN PARK				•	
RESERVE NUMBER	RESERVE	ADDRESS	FUTURE DOG PARK	ESTABLISHED DOG PARK	ON LEASH	OFF LEASH	DOG FREE
	EDINBURGH NORTH						
178	Ramsay Park, Edinburgh North	Womma Road, EDINBURGH NORTH				•	
179	Winterslow Road Reserve, Elizabeth	Dauntsey Road, ELIZABETH Winterslow Road, EDINBURGHNORTH			•		
180	Womma Park, Edinburgh North	Womma Road, EDINBURGH NORTH				•	
181	Womma Road Reserve, Edinburgh North	Womma Road, EDINBURGH NORTH				•	

RESERVE NUMBER	RESERVE	ADDRESS	FUTURE DOG PARK	ESTABLISHED DOG PARK	ON LEASH	OFF LEASH	DOG FREE AREAS
	ELIZABETH						
182	Ashfield Road Reserve, Elizabeth	Main North Road, ELIZABETH	•			•	
183	Central Districts Oval, Elizabeth	Goodman Road, ELIZABETH					•
184	Clifton Gardens, Elizabeth	Enford Street, ELIZABETH			•		
185	Langford Drive Reserve, Elizabeth	Langford Drive, ELIZABETH				•	
186	Playford Gardens, Elizabeth	Goodman Road, ELIZABETH		•			
187	Ridley Reserve, Elizabeth Grove	Fairfield Road, ELIZABETH Ridley Road, ELIZABETH				•	•
188	Winterslow Road Reserve, Elizabeth	Dauntsey Road, ELIZABETH Winterslow Road, EDINBURGH NORTH				•	•

RESERVE NUMBER	RESERVE	ADDRESS	FUTURE DOG PARK	ESTABLISHED DOG PARK	ON LEASH	OFF LEASH	DOG FREE AREAS
	ELIZABETH DOWNS						
189	Adams Road Screening Reserve, Elizabeth Downs	Linger Crescent, ELIZABETH DOWNS			•	•	
190	Argana Park, Elizabeth Downs	Mavros Road, ELIZABETH DOWNS			•	•	
191	Baker Street Screening Reserve, Elizabeth Downs	Baker Street, ELIZABETH DOWNS				•	
192	Barrington Road Windbreak	Barrington Road, ELIZABETH DOWNS				•	
193	Barritt reserve, Elizabeth Downs	Haldane Street, ELIZABETH DOWNS				•	

194	Bloomfield Reserve, Elizabeth Downs	Bloomfield Crescent, ELIZABETH DOWNS			•		
195	Brian Coward Reserve, Elizabeth Downs	Forrestall Road, ELIZABETH DOWNS Uley Road, ELIZABETH DOWNS				•	
196	Burdell Reserve, Elizabeth Downs	Turnbull Road, ELIZABETH DOWNS			•		
197	Fillsoll Crescent Reserve, Elizabeth Downs	Fillsoll Crescent, ELIZABETH DOWNS			•		
198	Hamblynn Road Screening Reserve, Elizabeth Downs	Hamblynn Road, ELIZABETH DOWNS			•		
199	Hanson Road Screening Reserve, Elizabeth Downs	Linger Crescent, ELIZABETH DOWNS				•	
200	Hanson Road/Stakes Crescent Walkway	Stakes Crescent, ELIZABETH DOWNS			•		
201	Loftis Road Reserve, Elizabeth Downs	Loftis Road, ELIZABETH DOWNS			•		
202	Marcian Avenue Reserve, Elizabeth Downs	Main North Road, ELIZABETH DOWNS				•	
203	Marcian/Justinian Walkway	Marcian Avenue, ELIZABETH DOWNS			•		
204	McKenzie Road Reserve, Elizabeth Downs	Main North Road, ELIZABETH DOWNS				•	
205	Pipeline Corridor, Elizabeth Downs	Barrington Road, ELIZABETH DOWNS Dauntless Crescent, ELIZABETH DOWNS Yorktown Road, ELIZABETH DOWNS				•	
206	Uley Road Screening Reserve, Blakeview	Drage Street, ELIZABETH DOWNS Main North Road, BLAKEVIEW Uley Road, BLAKEVIEW				•	
207	Uley Park Reserve, Elizabeth Downs	Uley Road, ELIZABETH DOWNS			•		
208	Uley Road Sportsfield, Elizabeth Downs	Linger Crescent, ELIZABETH DOWNS Uley Road, ELIZABETH DOWNS Uley Road, ELIZABETH DOWNS				•	•
209	St Leonards Reserve, Elizabeth Downs	Wasley Street, ELIZABETH DOWNS			•		
210	Stratton Road Reserve, Elizabeth Downs	Adams Road, ELIZABETH DOWNS			•	•	
211	Waters Crescent Reserve, Elizabeth Downs	Hamblynn Road, ELIZABETH DOWNS			•		
212	Yorktown Road Reserve, Elizabeth Downs	Yorktown Road, ELIZABETH DOWNS Yorktown Road, ELIZABETH DOWNS				•	

RESERVE NUMBER	RESERVE	ADDRESS	FUTURE DOG PARK	ESTABLISHED DOG PARK	ON LEASH	OFF LEASH	DOG FREE AREAS
	ELIZABETH EAST						
213	Ballard Street Reserve, Elizabeth East	Blackburn Road, ELIZABETH EAST				•	
214	Ballard Street Reserve, Elizabeth East	Ballard Street, ELIZABETH EAST			•		
215	Bellinger Road Reserve, Elizabeth East	Main North Road, ELIZABETH EAST				•	
216	Blackburn Road & Birchdale Reserves, Elizabeth East	Hollyoake Court, HILLBANK Blackburn Road, ELIZABETH EAST				•	
217	Cardnell Crescent Reserve, Elizabeth East	Cardnell Crescent, ELIZABETH EAST				•	
218	Conyngham Street Reserve, Elizabeth East	Conyngham Street, ELIZABETH EAST			•		
219	Derrick Road Reserve, Elizabeth East	Derrick Road, ELIZABETH EAST				•	
220	Dolphin Reserve, Elizabeth East	Dolphin Street, ELIZABETH EAST			•		
221	Grenadier Road Reserve, Elizabeth East	Blackburn Road, ELIZABETH EAST			•	•	
222	Grenadier Road Reserve, Elizabeth East	Grenadier Road, ELIZABETH EAST			•	•	
223	Hughes Court Reserve, Elizabeth East	Blackburn Road, ELIZABETH EAST				•	
224	Jubilee Park, Elizabeth East	Midway Road, ELIZABETH EAST	•		•	•	
225	Kibby Road Reserve, Elizabeth East	Main North Road, ELIZABETH EAST				•	
226	Kinkaid Reserve, Elizabeth East	Kinkaid Road, ELIZABETH EAST			•	•	
227	Kinkaid Road Reserve, Elizabeth East	Midway Road, ELIZABETH EAST				•	
228	Main North Road Reserve, Elizabeth East	Main North Road, ELIZABETH EAST				•	
229	Nautilus Road Reserve, Elizabeth East	Portland Road, ELIZABETH EAST				•	
230	Nimitz Road Reserve, Elizabeth East	Main North Road, ELIZABETH EAST				•	
231	Northampton Crescent Reserve, Elizabeth East	Northampton Crescent, ELIZABETH EAST				•	
232	Phelps Street Reserve, Elizabeth East	Blackburn Road, ELIZABETH EAST Phelps Street, ELIZABETH EAST				•	
233	Rhine Court Reserve, Elizabeth East	Rhine Court, ELIZABETH EAST				•	
234	Shannon Street Reserve, Elizabeth East	Shannon Street, ELIZABETH EAST				•	

235	Spruance Reserve, Elizabeth East	Spruance Road, ELIZABETH EAST			•		
-----	----------------------------------	-------------------------------	--	--	---	--	--

RESERVE NUMBER	RESERVE	ADDRESS	FUTURE DOG PARK	ESTABLISHED DOG PARK	ON LEASH	OFF LEASH	DOG FREE AREAS
	ELIZABETH GROVE						
236	Argent Street Reserve, Elizabeth Grove	Deptford Street, ELIZABETH GROVE			•		
237	Blencowe Reserve, Elizabeth Grove	Blencowe Street, ELIZABETH GROVE				•	
238	Burgate Street Reserve, Elizabeth Grove	Argent Street, ELIZABETH GROVE			•		
239	Grateley Marnhull Reserve, Elizabeth Grove	Grateley Street, ELIZABETH GROVE	•			•	
240	Haynes Reserve, Elizabeth Grove	Gunther Street, ELIZABETH GROVE			•		
241	Ridley Reserve, Elizabeth Downs	Fairfield Road, ELIZABETH GROVE Ridley Road, ELIZABETH GROVE					•
242	Sandleheath Road Reserve, Elizabeth Downs	Main North Road, ELIZABETH GROVE				•	
243	Secombe Street Reserve, Elizabeth Downs	Secombe Street, ELIZABETH GROVE				•	

RESERVE NUMBER	RESERVE	ADDRESS	FUTURE DOG PARK	ESTABLISHED DOG PARK	ON LEASH	OFF LEASH	DOG FREE AREAS
	ELIZABETH NORTH						
244	Braemore Reserve, Elizabeth North	Braemore Street, ELIZABETH NORTH			•	•	
245	Broadmeadows Reserve, Elizabeth North	Casterley Road, ELIZABETH NORTH			•		
246	Broadmeadows Reserve, Elizabeth North	Tidworth Road, ELIZABETH NORTH			•		
247	Broadmeadows Road Reserve, Elizabeth North	Broadmeadows Road, ELIZABETH NORTH			•		
248	Dauntsey Reserve, Elizabeth North	Dauntsey Road, ELIZABETH NORTH				•	
249	Dauntsey Road Reserve, Elizabeth North	Womma Road, ELIZABETH NORTH				•	
250	Hillcott Reserve, Elizabeth North	Figsbury Street, ELIZABETH NORTH			•		
251	Maitland Street Walkway	Whitsbury Road, ELIZABETH NORTH				•	
252	Pertwood Reserve, Elizabeth North	Tisbury Street, ELIZABETH NORTH				•	
253	Rosewood Park, Woodford Road Reserve, Elizabeth	Woodford Road, ELIZABETH NORTH			•		

254	Sedgehill Reserve	Sedgehill Road, ELIZABETH NORTH				•	
-----	-------------------	---------------------------------	--	--	--	---	--

RESERVE NUMBER	RESERVE	ADDRESS	FUTURE DOG PARK	ESTABLISHED DOG PARK	ON LEASH	OFF LEASH	DOG FREE AREAS
	ELIZABETH NORTH						
255	St Barbra Road Reserve, Elizabeth North	Broadmeadows Road, ELIZABETH NORTH				•	
256	Tisbury Street Reserve, Elizabeth North	Tisbury Street, ELIZABETH NORTH Broadmeadows Road, ELIZABETH NORTH				•	
257	Whitsbury Road Walkway	Whitsbury Road, ELIZABETH NORTH			•		
258	Womma Road Reserve, Elizabeth North	Tisbury Street, ELIZABETH NORTH				•	
259	Yarnbury Road Reserve, Elizabeth North	Fisherton Street, ELIZABETH NORTH Yarnbury Road, ELIZABETH NORTH				•	

RESERVE NUMBER	RESERVE	ADDRESS	FUTURE DOG PARK	ESTABLISHED DOGPARK	ON LEASH	OFF LEASH	DOG FREE AREAS
	ELIZABETH PARK						
260	Adams Road Reserve, Elizabeth Park	Adams Road, ELIZABETH PARK				•	
261	Davey Street Reserve, Elizabeth Park	Davey Street, ELIZABETH PARK				•	
262	Dwight Reserve, Elizabeth Park	Yorktown Road, ELIZABETH PARK				•	
263	Fremont Park, Elizabeth Park	Yorktown Road, ELIZABETH PARK	•		•		
264	Garlick Road Reserve, Elizabeth Park	Main North Road, ELIZABETH PARK				•	
265	Gould Road Reserve, Elizabeth Park	Grant Street, ELIZABETH PARK				•	
266	Ifould Road Reserve, Elizabeth Park	Ifould Road, ELIZABETH PARK			•		
267	Midway Road Reserve, Elizabeth Park	Midway Road, ELIZABETH PARK				•	
268	Olive Grove, Elizabeth Park	Shillabeer Road, ELIZABETH PARK				•	
269	Peterswool Road Reserve, Elizabeth Park	Main North Road, ELIZABETH PARK				•	
270	Turner Drive Reserve, Elizabeth Park	Turner Drive, ELIZABETH PARK				•	
271	Yorktown Road Reserve, Craigmore	Yorktown Road, ELIZABETH PARK				•	

RESERVE NUMBER	RESERVE	ADDRESS	FUTURE DOG PARK	ESTABLISHED DOG PARK	ON LEASH	OFF LEASH	DOG FREE AREAS
ELIZABETH SOUTH							
272	Bubner Street Reserve, Elizabeth South	Bubner Street, ELIZABETH SOUTH				•	
273	Chivell Street Drainage Reserve	Chivell Street, ELIZABETH SOUTH			•		
274	Dyke Court Reserve, Elizabeth South	Dyke Court, ELIZABETH SOUTH			•		
275	Goodman Road Reserve, Elizabeth	Goodman Road, ELIZABETH SOUTH				•	
276	Hogarth Road Reserve, Elizabeth South	Hogarth Road, ELIZABETH SOUTH				•	
277	Kettering Road Reserve, Elizabeth South	Kettering Road, ELIZABETH SOUTH				•	
278	Manningford Road Reserve, Elizabeth South	Bagot Road, ELIZABETH SOUTH			•		
279	O'Leary Road Reserve, Elizabeth South	Blake Road, ELIZABETH SOUTH Hogarth Road, ELIZABETH SOUTH Whitford Road, ELIZABETH SOUTH				•	
280	Ridley Road Reserve, Elizabeth South	Whitford Road, ELIZABETH SOUTH			•		
281	Virgo Street Reserve, Elizabeth South	Thompson Street, ELIZABETH SOUTH			•		
282	Willison Road Reserve, Elizabeth South	Goodman Road, ELIZABETH SOUTH			•		

RESERVE NUMBER	RESERVE	ADDRESS	FUTURE DOG PARK	ESTABLISHED DOG PARK	ON LEASH	OFF LEASH	DOG FREE AREAS
ELIZABETH VALE							
283	Boundary Park, Elizabeth Vale	Coppleridge Drive, ELIZABETH VALE				•	
284	Collingbourne Drive Reserve, Elizabeth Vale	Collingbourne Drive, ELIZABETH VALE				•	
285	Corton Street Reserve, Elizabeth Vale	Corton Street, ELIZABETH VALE			•		
286	Corton Street, Elizabeth Vale	Corton Street, ELIZABETH VALE			•		
287	Duncan Anderson & Mofflin Reserves, Elizabeth Vale	Mofflin Road, ELIZABETH VALE				•	•
288	Hamdon Street Reserve, Elizabeth Vale	John Rice Avenue, ELIZABETH VALE				•	
289	Haydown Road Reserve, Elizabeth Vale	Haydown Road, ELIZABETH VALE			•		

290	Joel Crescent & Hogarth Reserves, Elizabeth Vale	Cameron Road, ELIZABETH VALE Hogarth Road, ELIZABETH VALE John Rice Avenue, ELIZABETH VALE				•	
291	John Rice Avenue Reserve, Elizabeth Vale	Coppleridge Drive, ELIZABETH VALE John Rice Avenue, ELIZABETH VALE Main North Road, ELIZABETH VALE				•	
292	John Rice Avenue/Rollison Road Walkway	Rollison Road, ELIZABETH VALE			•		
293	Oldham Road Reserve, Elizabeth Vale	Oldham Road, ELIZABETH VALE				•	
294	Semley Street, Elizabeth Vale	John Rice Avenue, ELIZABETH VALE			•		

RESERVE NUMBER	RESERVE	ADDRESS	FUTURE DOG PARK	ESTABLISHED DOG PARK	ON LEASH	OFF LEASH	DOG FREE AREAS
	EYRE						
295	Eyre Sports Park, Eyre	Edward John Parade, EYRE			•	•	
296	Burke Circuit, Eyre	Burke Circuit, EYRE			•	•	
297	Eyre Circuit, Eyre	Eyre Circuit, EYRE			•	•	

RESERVE NUMBER	RESERVE	ADDRESS	FUTURE DOG PARK	ESTABLISHED DOGPARK	ONLEASH	OFFLEASH	DOGFREE AREAS
	GOULD CREEK						
298	Little Para River Reserve, Hillbank	Williams Road, GOULD CREEK				•	

RESERVE NUMBER	RESERVE	ADDRESS	FUTURE DOG PARK	ESTABLISHED DOGPARK	ONLEASH	OFFLEASH	DOGFREE AREAS
	HILLBANK						
299	Argyle Reserve, Hillbank	Argyle Walk, HILLBANK				•	
300	Ashwood Boulevard Screening Reserve	Ashwood Boulevard, HILLBANK			•		
301	Ashwood Watercourse, Hillbank	Willow Gardens, HILLBANK Ashwood Boulevard, HILLBANK Linwood Grove, HILLBANK Landseer Place, HILLBANK Coach House Mews, HILLBANK				•	
302	Berkley Reserve, Hillbank	Berkley Way, HILLBANK				•	
303	Berwick Rise, Hillbank	Crestview Place, HILLBANK				•	
304	Blackburn Road & Birchdale Reserves, Elizabeth East	Holyoake Court, HILLBANK Blackburn Road, ELIZABETH EAST				•	
305	Blackburn Road Screening Reserve	Blackburn Road, HILLBANK				•	
306	Blight Crescent	Blight Crescent, HILLBANK				•	

307	Bungarra Reserve, Hillbank	Bungarra Street, HILLBANK				•	
308	Cambridge Terrace Linear Reserve	Cambridge Terrace, HILLBANK				•	
309	Cambridge Terrace Screening Reserve, Hillbank	Cambridge Terrace, HILLBANK				•	
310	Cambridge/Kosmina Reserve	Kosmina Crescent, HILLBANK				•	
311	Chesterfield Walk Screening Reserve, Hillbank	Ashwood Boulevard, HILLBANK				•	
312	Christine Avenue Screening Reserve, Hillbank	Christine Avenue, HILLBANK				•	
313	Christine Reserve, Hillbank	Christine Avenue, HILLBANK				•	
314	Coach House Mews Reserve	Coach House Mews, HILLBANK				•	
315	Grandview Reserve, Hillbank	Grandview Drive, HILLBANK				•	
316	Green Reserve, Hillbank	Anthony Drive, HILLBANK Black Top Drive, HILLBANK				•	
317	Gloaming Reserve, Hillbank	Gloaming Close, HILLBANK			•		
318	Henryk Reserve, Hillbank	Lot 204 Marian Crescent, HILLBANK			•		
319	Henryk/Kosmina Reserve & Charles Way Reserve, Hillbank	Kosmina Crescent, HILLBANK Skyline Drive, HILLBANK Stanley Street, HILLBANK Anthony Drive, HILLBANK Charles Way, HILLBANK				•	
320	Highfield Drive Drainage Reserve	Lot 665 Highfield Drive, HILLBANK				•	
321	Hillbank Trail North, Hillbank	Brooker Drive, HILLBANK Christine Avenue, HILLBANK Cambridge Terrace, HILLBANK Brackenmoor Close, HILLBANK				•	
322	Holyoake East Reserve, Hillbank	Argyle Walk, HILLBANK				•	
323	Honeysuckle Reserve, Hillbank	235 Ashwood Boulevard, HILLBANK			•		
324	Jo Gapper Activity Park, Hillbank	Blackburn Road, HILLBANK		•			
325	Ken Patterson Reserve, Hillbank	Black Top Road, HILLBANK				•	
326	Kensington Mews Screening Reserve, Hillbank	Knightsbridge Court, HILLBANK				•	
327	Kosmina/Stanley Reserve, Hillbank	Stanley Street, HILLBANK				•	
328	Kylie Reserve, Hillbank	Bungarra Street, HILLBANK Kylie Crescent, HILLBANK				•	
329	Landseer Place Reserve	Landseer Place, HILLBANK				•	
330	Little Para River Reserve	Black Top Road, HILLBANK				•	
331	Knightsbridge Court	Knightsbridge Court, HILLBANK			•		
332	Michael Reserve, Hillbank	Michael Crescent, HILLBANK				•	
333	Norway Reserve, Hillbank	Highfield Drive, HILLBANK				•	
334	Pacific Boulevard/Blackburn Walkway	Pacific Boulevard, HILLBANK				•	
335	Prelude Reserve, Hillbank	Prelude Circuit, HILLBANK				•	

336	Promotion Drive Reserve, Hillbank	Blackburn Road, HILLBANK Promotion Drive, HILLBANK				•	
337	Rhodes Reserve, Hillbank	Brooker Drive, HILLBANK Cambridge Terrace, HILLBANK				•	
338	Richardsons Creek, Hillbank	Rosebank Crescent, HILLBANK Tarana Court, HILLBANK Tobin Court, HILLBANK				•	
339	Robert Reserve, Hillbank	Robert Road, HILLBANK				•	
340	Sanctuary Rise Reserve	Hillbank Drive, Hillbank			•	•	
341	Sarah Court Screening Reserve, Hillbank	Sarah Court, HILLBANK Williams Rd, HILLBANK				•	
342	Skyline Reserve North, Hillbank	Black Top Road, HILLBANK Skyline Drive, HILLBANK			•	•	
343	Snell Avenue Reserve, Hillbank	Bungarra Street, HILLBANK			•		
344	Stanley Street Screening Reserve, Hillbank	Main North Road, HILLBANK				•	
345	Stanley Street/Main North Road Walkway	Stanley Street, HILLBANK			•		
346	The Lodge, Hillbank	Ashwood Boulevard, HILLBANK			•		
347	Victor Place Drainage Reserve, Hillbank	Menka Street, HILLBANK			•		
348	Victor Place Reserve, Hillbank	Victor Place, HILLBANK				•	
349	Whitford Bushland Reserve	Whitford road, HILLBANK			•		•
350	Williams Road Reserve, Hillbank	Williams Road, HILLBANK				•	
351	Willison Road Screening Reserve, Hillbank	Willison Road, HILLBANK				•	
352	Willison/Ashwood Screening Reserve	Willison Road, HILLBANK			•		
353	Winston Reserve, Hillbank	Winston Crescent, HILLBANK Highfield Drive, HILLBANK			•		

RESERVE NUMBER	RESERVE	ADDRESS	FUTURE DOG PARK	ESTABLISHED DOG PARK	ON LEASH	OFF LEASH	DOG FREE AREAS
	HUMBUG SCRUB						
354	Kelly's Hill Reserve, Humbug Scrub	Kelly's Hill Road, HUMBUG SCRUB			•		
355	Kersbrook Reserve, Humbug Scrub	Kersbrook Road, HUMBUG SCRUB					•
356	Taylor/Tenafeate Reserve	Taylors Road, HUMBUG SCRUB			•		
357	Taylor's Reserve, Humbug Scrub	Taylors Road, HUMBUG SCRUB			•		

RESERVE NUMBER	RESERVE	ADDRESS	FUTURE DOG PARK	ESTABLISHED DOG PARK	ON LEASH	OFF LEASH	DOG FREE AREAS
MUNNO PARA							
358	Carrama Crescent Screening Reserve, Munno Para	Carrama Crescent, MUNNO PARA				•	
359	Carrama Reserve, Munno Para	Myall Avenue, MUNNO PARA				•	
360	Coventry Road, Munno Para	Coventry Road, MUNNO PARA			•	•	
361	Douglas Drive, Munno Para	Douglas Drive, MUNNO PARA				•	
362	Karri Reserve, Munno Para	Alawoona Road, MUNNO PARA				•	
363	Maltarra /Carcoola road Screening Reserve, Munno Para	Carcoola Road, MUNNO PARA Maltarra Road, MUNNO PARA Myall Avenue, MUNNO PARA			•		
364	Munno Para Linear Reserve-North, Munno Para	Alawoona Road, MUNNO PARA				•	
365	Munno Para Linear Reserve-South, Munno Para	Koongarra Crescent, MUNNO PARA			•		
366	Munno Para Railway Reserve, Munno Para	Alawoona Road, MUNNO PARA				•	
367	Munno Para Wetlands, Munno Para	Curtis Road, MUNNO PARA Douglas Drive, MUNNO PARA			•		
368	Nolan Reserve, Munno Para	Nolan Place, MUNNO PARA			•	•	
369	Playford Alive Town Park	Peachey Road, MUNNO PARA			•		
370	Stebonheath Wetlands, Munno Para	Curtis Road, MUNNO PARA			•		

RESERVE NUMBER	RESERVE	ADDRESS	FUTURE DOG PARK	ESTABLISHED DOG PARK	ON LEASH	OFF LEASH	DOG FREE AREAS
MUNNO PARA WEST							
371	Ascot Avenue, Munno Para West	Ascot Avenue, Munno Para West			•		
372	Blandy Court Screening Reserve, Munno Para West	Blandy Court, MUNNO PARA WEST			•		
373	Chellaston Reserve, Munno Para West	Chellaston Road, MUNNO PARA WEST			•	•	
374	Maple Street Reserve, Munno Para West	Maple Street, MUNNO PARA WEST			•	•	

RESERVE NUMBER	RESERVE	ADDRESS	FUTURE DOG PARK	ESTABLISHED DOG PARK	ON LEASH	OFF LEASH	DOG FREE AREAS
ONE TREE HILL							
375	Blencowe Reserve, One Tree Hill	Precolumb Road, ONE TREE HILL			•		

376	Burnett Walk, One Tree Hill	Burnett Drive, ONE TREE HILL			•		
377	Cornishman’s Reserve, One Tree Hill	Cornishman’s Hill Road, ONE TREE HILL			•		
378	Institute Reserve	McGilp Road, ONE TREE HILL			•		
379	Jordan Reserve, One Tree Hill	Jordan Drive, ONE TREE HILL Burnett Drive, ONE TREE HILL				•	
380	Lorna Court Reserve, One Tree Hill	Lorna Court, ONE TREE HILL				•	
381	McGilp Recreation Reserve, One Tree Hill	McGilp Road, ONE TREE HILL			•		
382	Precolumb Reserve, One Tree Hill	Blencowe Road, ONE TREE HILL			•		
383	Wood Reserve, One Tree Hill	Black, ONE TREE HILL			•		

RESERVE NUMBER	RESERVE	ADDRESS	FUTURE DOG PARK	ESTABLISHED DOG PARK	ON LEASH	OFF LEASH	DOG FREE AREAS
	PENFIELD						
384	Argent Road Drainage Reserve, Penfield	Argent Road, PENFIELD			•		
385	Open Space Reserves, Penfield	Andrews Road, PENFIELD Petherton Road, PENFIELD			•		

RESERVE NUMBER	RESERVE	ADDRESS	FUTURE DOG PARK	ESTABLISHED DOG PARK	ON LEASH	OFF LEASH	DOG FREE AREAS
	PENFIELD GARDENS						
386	Carclew Cemetery	Carclew Road, PENFIELD GARDENS			•		
387	McGee Road/Gawler River Watercourse	Gawler River, PENFIELD GARDENS			•		

RESERVE NUMBER	RESERVE	ADDRESS	FUTURE DOG PARK	ESTABLISHED DOG PARK	ON LEASH	OFF LEASH	DOG FREE AREAS
	SAMPSON FLAT						
388	Kersbrook Road Reserve	Kersbrook Road, SAMPSON FLAT			•		
389	Rutland Drive Reserve	Shillabeer Road, SAMPSON FLAT			•		

	SMITHFIELD						
390	Anderson Walk Screening Reserve	Anderson Walk, SMITHFIELD Main North Road, SMITHFIELD			•		
391	Augusta Square, Smithfield	Augusta Square, SMITHFIELD				•	
392	Harold Wissell Reserve, Smithfield	Morialta Drive, SMITHFIELD			•		

393	Lucy Reserve, Smithfield	Samuel Street, SMITHFIELD				•	
394	Lucy Street Drainage Reserve, Smithfield	Samuel Street, SMITHFIELD				•	
395	Samuel Street Drainage Reserve, Smithfield	Samuel Street, SMITHFIELD Curtis Road, SMITHFIELD				•	
396	Smithfield Oval, Smithfield	Anderson Walk, SMITHFIELD			•		

RESERVE NUMBER	RESERVE	ADDRESS	FUTURE DOG PARK	ESTABLISHED DOG PARK	ON LEASH	OFF LEASH	DOG FREE AREAS
	SMITHFIELD PLAINS						
397	Coventry Road Drainage Reserve, Smithfield Plains	Heddle Street, SMITHFIELD PLAINS Peachey Road, SMITHFIELD PLAINS				•	
398	Crittenden Road Drainage Reserve	Crittenden Road, SMITHFIELD PLAINS				•	
399	Davoren Road Screening Reserve, Smithfield Plains	Coventry Road, SMITHFIELD PLAINS				•	
400	Davison Crescent Screening Reserve, Smithfield Plains	Davison Road, SMITHFIELD PLAINS Curtis Road, SMITHFIELD PLAINS			•		
401	Hodby Screening Reserve, Smithfield Plains	Hodby Crescent, SMITHFIELD PLAINS				•	
402	Jessie Taylor Reserve, Smithfield Plains	Curtis Road, SMITHFIELD PLAINS			•	•	
403	Kooranowa Oval	Vincent Road, SMITHFIELD PLAINS Peachey Road, SMITHFIELD PLAINS			•	•	
404	Peachey Road Reserve	Peachey Road, SMITHFIELD PLAINS			•		
405	Peachey Road Drainage Reserve, Smithfield Plains	Peachey Road, SMITHFIELD PLAINS				•	
406	Roberts Reserve, Smithfield Plains	Roberts Crescent, SMITHFIELD PLAINS			•		
407	Saxon Street Dryland Reserve	66 Saxon Street, SMITHFIELD PLAINS			•		
408	Southan Street Screening Reserve, Smithfield Plains	Southan Street, SMITHFIELD PLAINS			•		
409	Stebonheath Drainage Reserve	Featherstone Street, SMITHFIELD PLAINS			•	•	
410	Tudor Crescent Dryland Reserve	Featherstone Street, SMITHFIELD PLAINS			•		

RESERVE NUMBER	RESERVE	ADDRESS	FUTURE DOG PARK	ESTABLISHED DOG PARK	ON LEASH	OFF LEASH	DOG FREE AREAS
	ULEYBURY						
411	Adams Road Park	Adams Road, ULEYBURY					•

	VIRGINIA						
412	Broster Road Screening Reserve, Virginia	Broster Road, VIRGINIA			•		
413	Coratina Reserve, Virginia	Coratina Road, VIRGINIA			•	•	
414	Gawler River/Baker Road Watercourse	Robinson Road, VIRGINIA			•		
415	Virginia Oval, Virginia	Old Port Wakefield Road, VIRGINIA			•		

	YATTALUNGA						
416	Glenburnie Reserve	Humbug Scrub Road, YATTALUNGA					•



DOG AND CAT MANAGEMENT PLAN

APPENDIX 3

MAPS

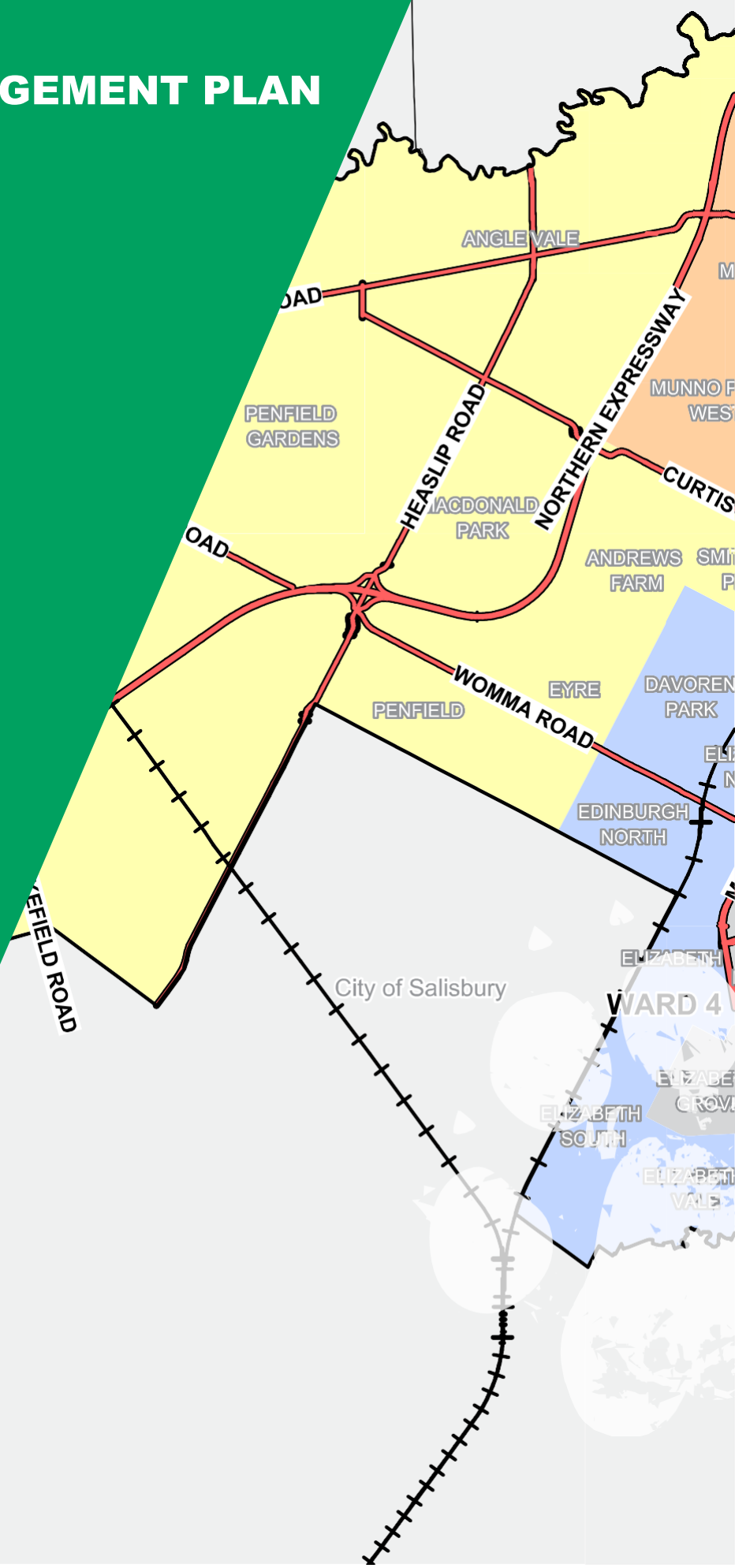

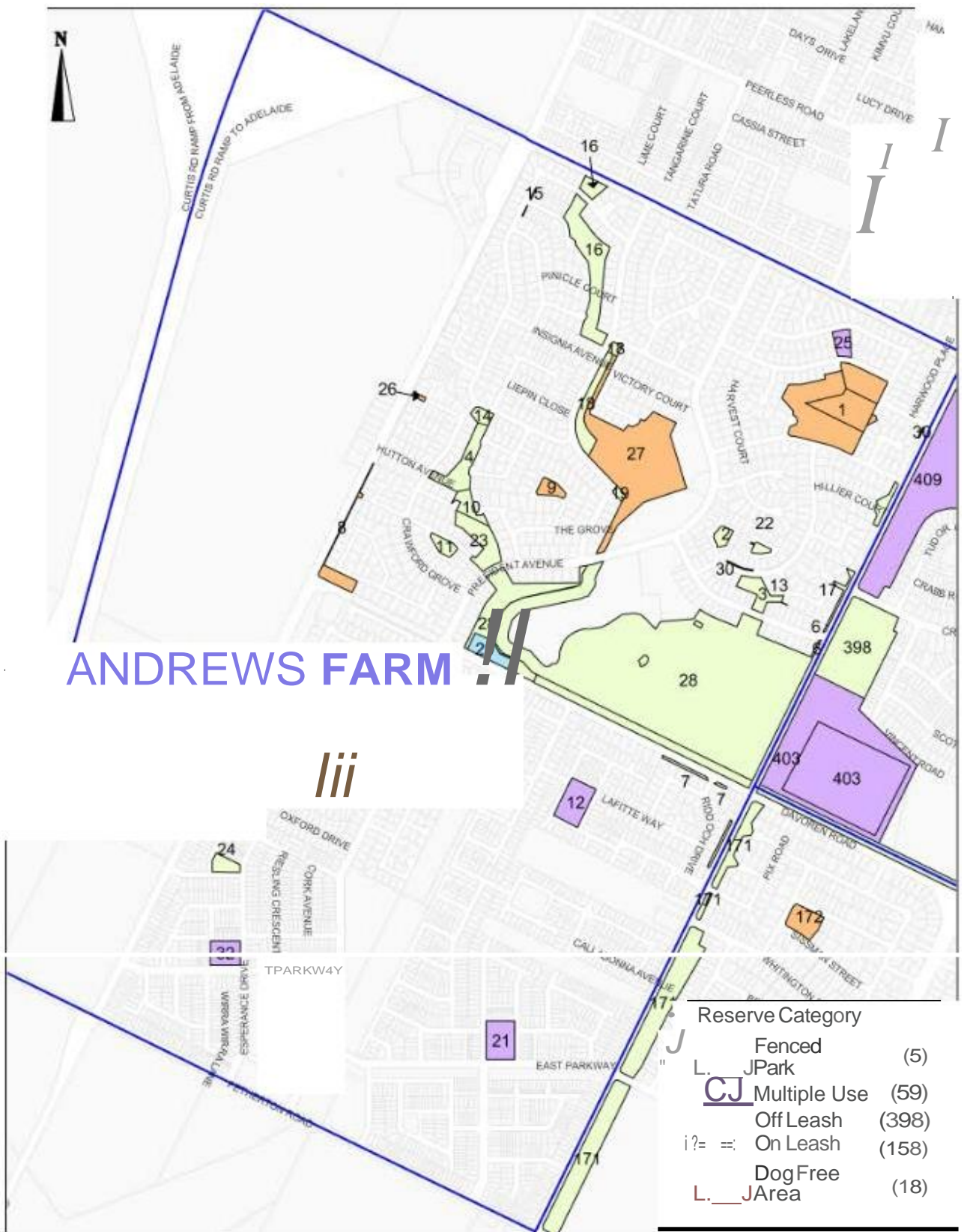

This map is a representation of the information currently held by the City of Playford. Data for roads, suburbs, wards and local government areas are supplied by the Department of Environment and Natural Resources. The map is compiled by AEROMedia Pty Ltd. No liability is accepted for any errors or omissions. Any feedback or comments should be appreciated. No part of this map may be reproduced in any form.

June 2018

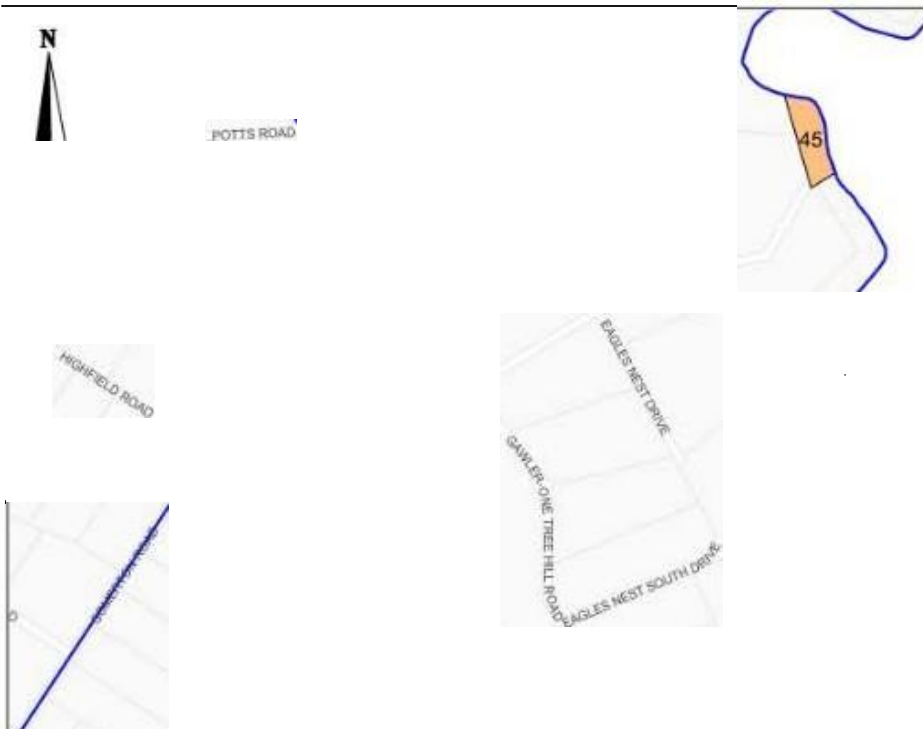

BIBARINGA



Reserve Category	
I:::JFenced Park	(5)
I:::JMultipleUse	(59)
I:::JOffLeash	(398)
I:::JOnLeash	(158)
C:::JDog Free Area	(18)



This map is a representation of the information currently held by The City of Playford. Cadastral, roads, and local government areas are supplied by the Department of Environment, Water and Natural Resources. The map is supplied by the City of Playford and is not a legal document. It is for information only and should not be used for any purpose other than that for which it was intended. The City of Playford does not accept any liability for any errors or omissions in this map. Feedback on any errors or omissions would be appreciated.

June 2018

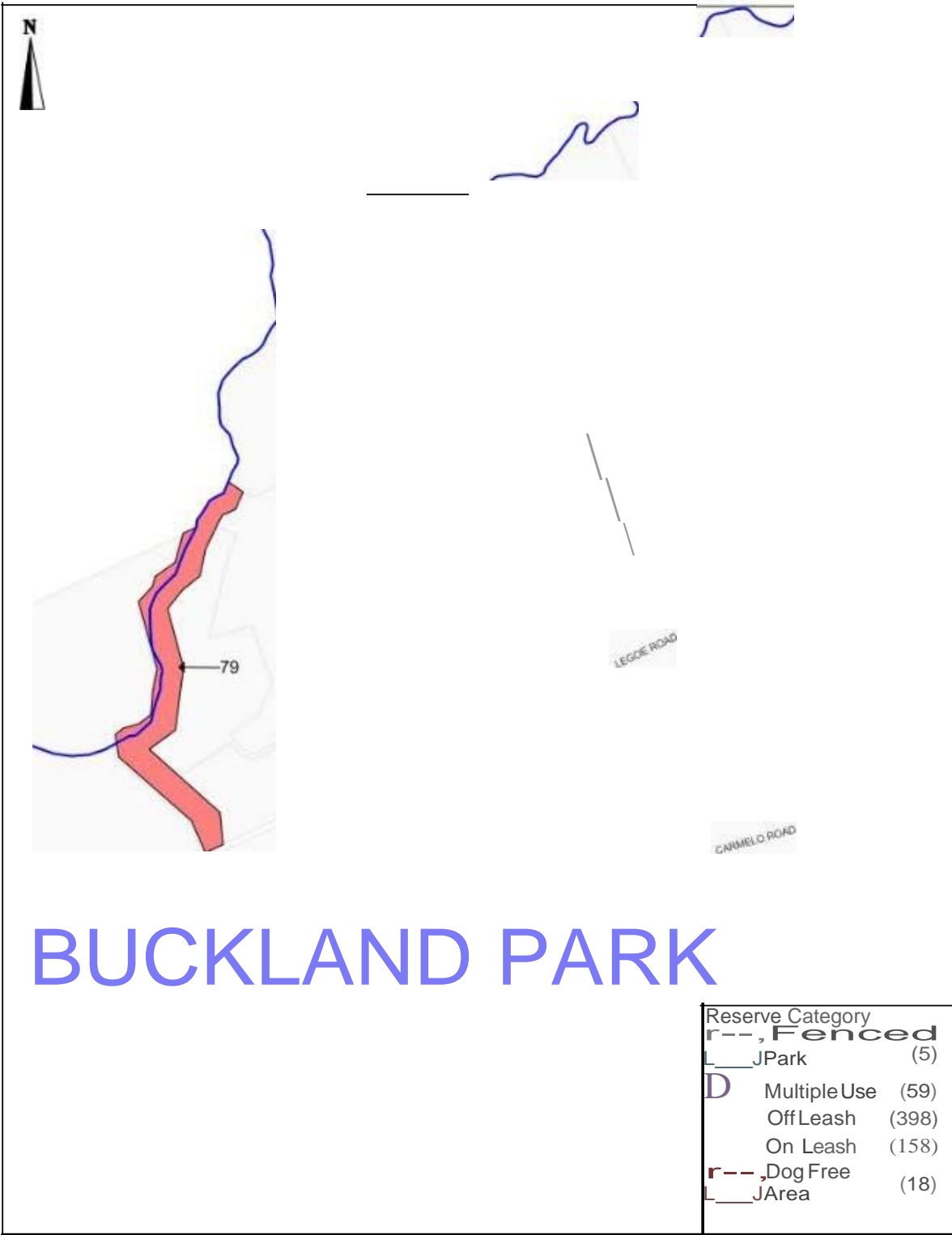

This map is a representation of the information currently held by The City of Playford. Cadastral roads, suburbs, ward and local government areas are supplied by the Department of Environment and Natural Resources. Aerial photography is supplied by Aerial Photography and Mapping, and the Millers Point. It has been made to ensure accuracy of the data. Council accepts no responsibility for any errors or omissions. My feedback on improvements would be appreciated. No part of this map may be copied or reproduced in any form.

June 2018

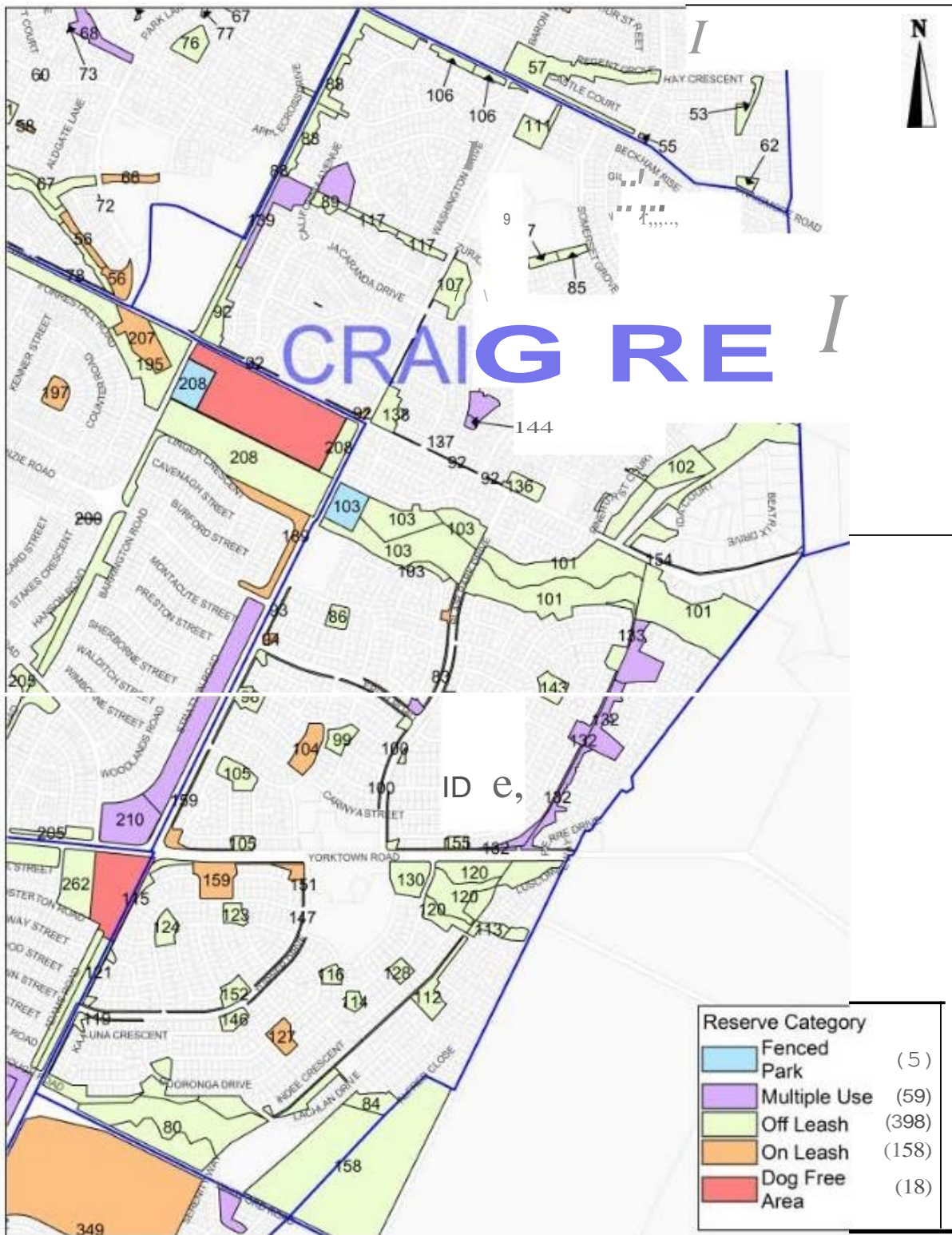

This map is a representation of the information currently held by The City of Playford. Cadastral roads, suburbs, ward and local government areas are supplied by the e-ep&1met14 or EnvirOt1ment. water&nclNatura,IResources AeN11Phc>tocta?hy 1, supplied by AE:ROmettex Ply LI OandNearMa;,PryLt<f 'Mille flWSY efforth.a-s been made to ensure meac:cu,acy Of r.t.s,tOdua.Council aoc:epcs no1ff9(1nslbih())'or any inVt or s or omissions.M y f&dback on omInloos or e<rors would be appreciated. No part of this map may be copied or reproduced in any form.

June 2018



HPWITTON ROAD



WESTPORT ROAD

EDINBURGH NORTH

BRADPOLE ROAD

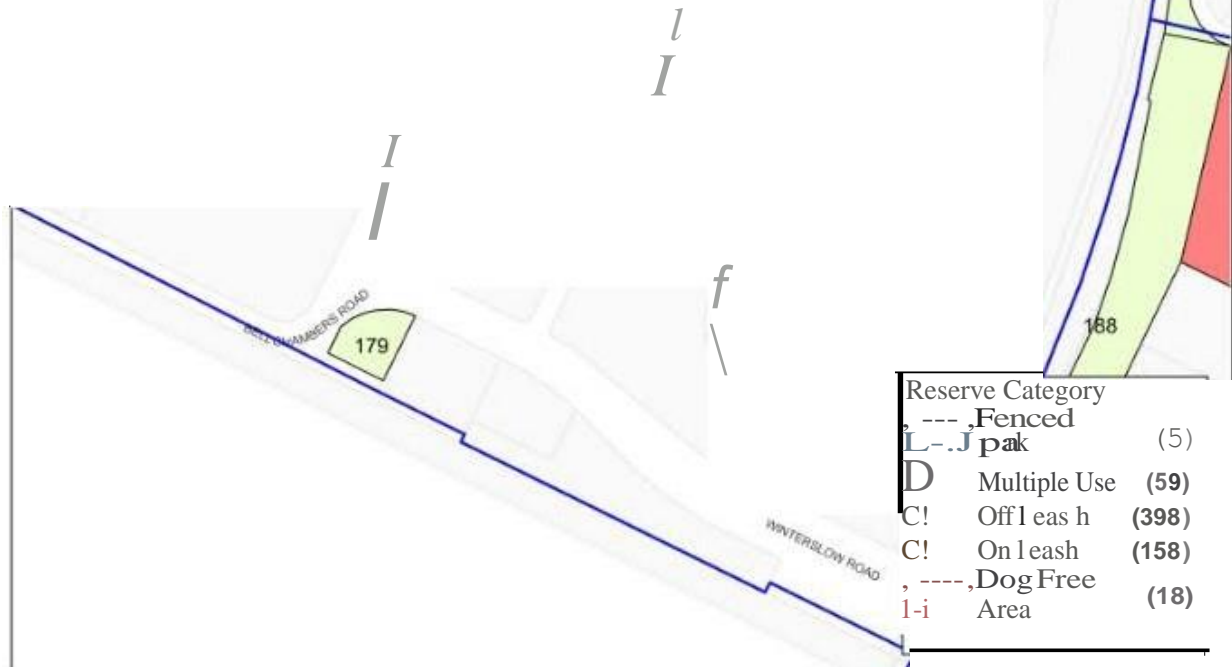

Reserve Category	
---	Fenced
L-J	Park (5)
D	Multiple Use (59)
C!	Off Leash (398)
C!	On Leash (158)
,---	Dog Free
1-i	Area (18)



This maps are presented to you for information only. The City of Playford does not warrant the accuracy of the information. The City of Playford does not accept any liability for any errors or omissions. My feedback on this map would be appreciated. No part of this map may be copied, reproduced or used in any form.

June 2018

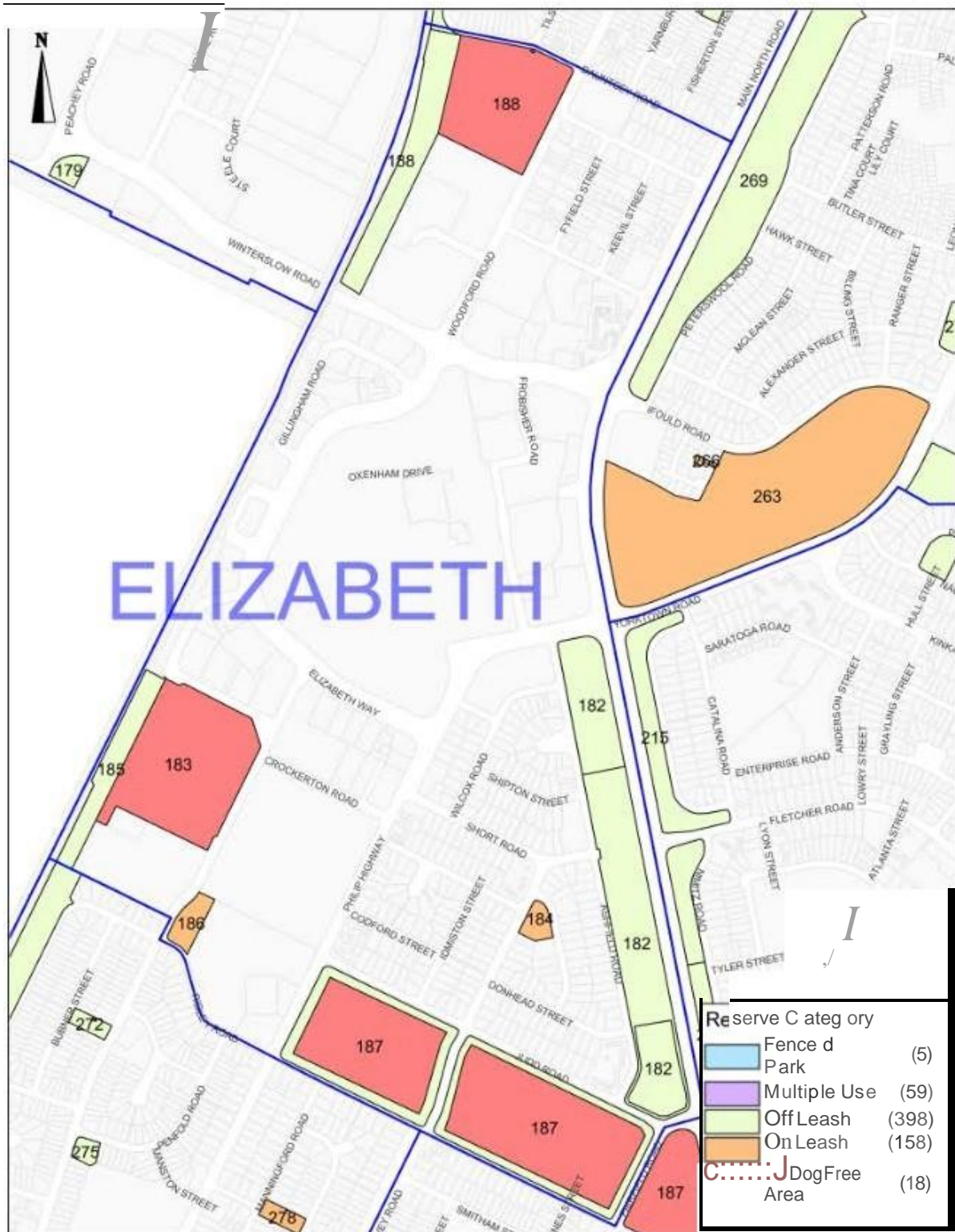

This map is a reproduction of the information held by the City of Playford. The City of Playford is not responsible for any errors or omissions in this map. The City of Playford is not responsible for any errors or omissions in this map. The City of Playford is not responsible for any errors or omissions in this map.

June 2018



This map is a representation of the information currently held by The City of Playford. Cadastre, roads, street names and local government areas are supplied by the Department of Environment, Water and Heritage. The map is based on aerial photography supplied by AEROMETRIX Pty Ltd and Nearmap Pty Ltd. The map is for information only and should not be used for any other purpose. The City of Playford is not responsible for any errors or omissions. Any feedback or comments should be sent to the City of Playford. No part of this map may be copied or reproduced in any form.

June 2018

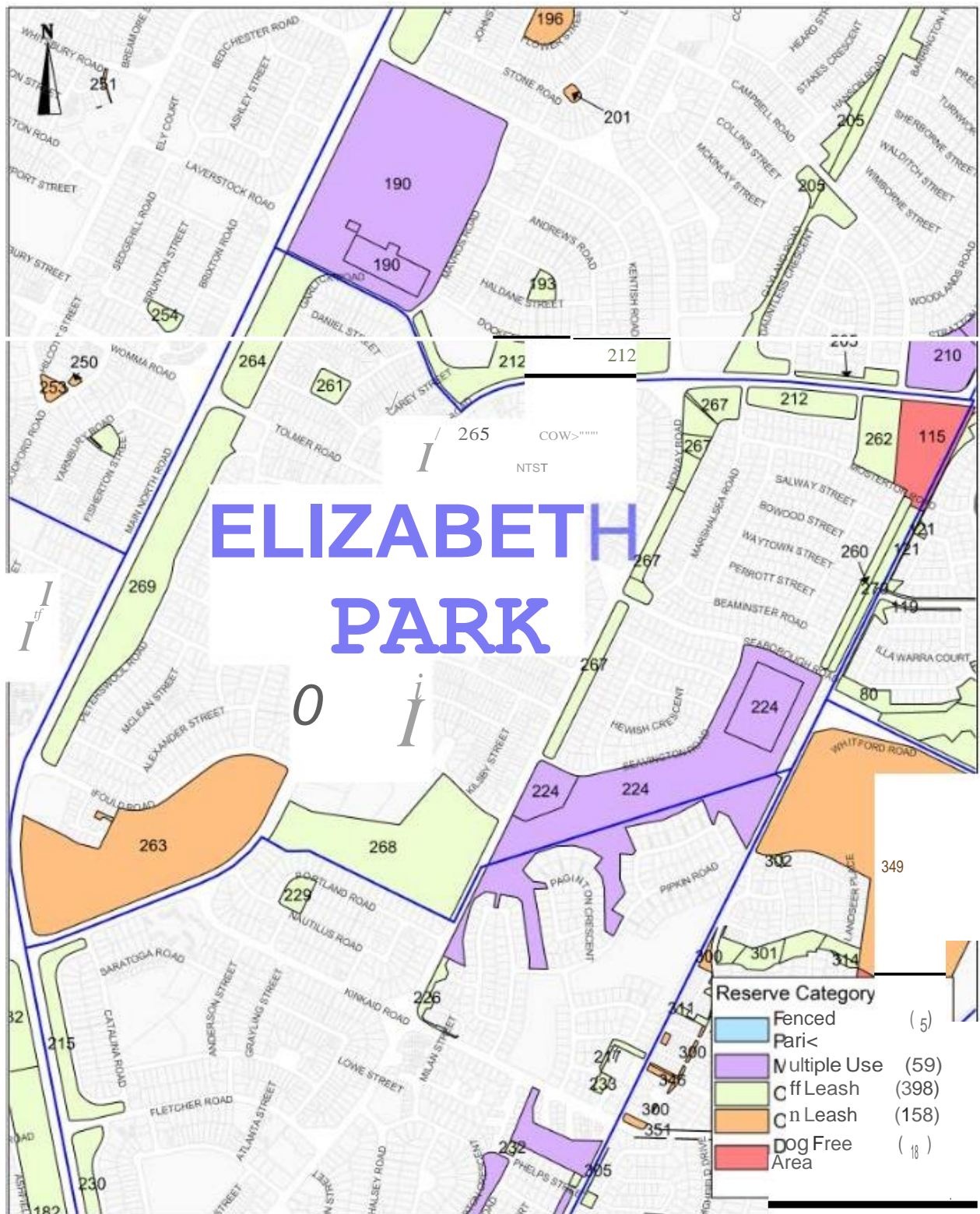

Q.1/K

This map is a representation of the information currently held by The City of Playford. The City of Playford is not responsible for any errors or omissions in this map. The City of Playford is not responsible for any errors or omissions in this map. The City of Playford is not responsible for any errors or omissions in this map.

June 2018

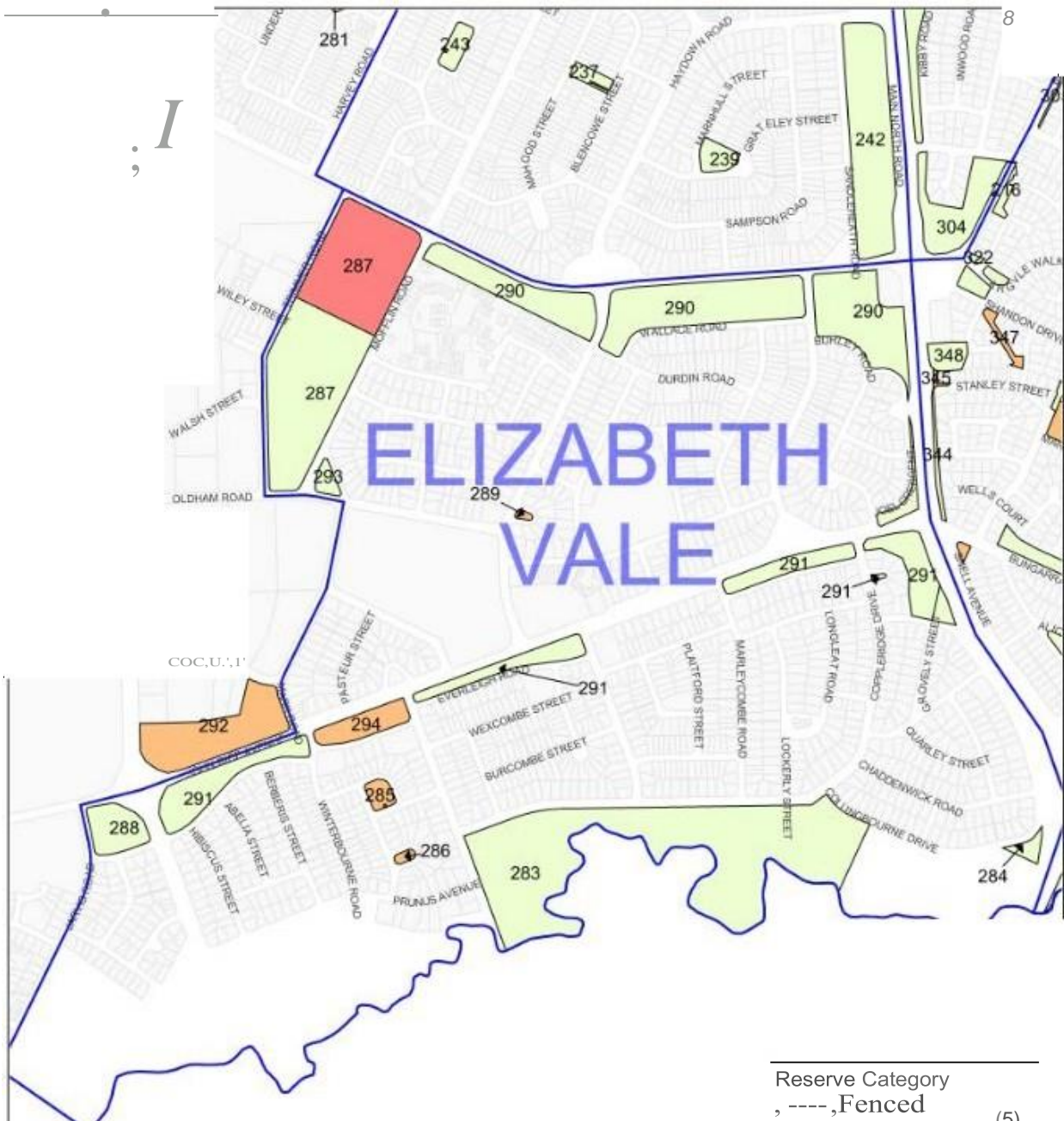

clon o,

f<r-'

This map is a representation of the information currently held by The City of Playford Cadastre, roads, suburbs, ward and local government areas are supplied by the Department of Environment, Water and Natural Resources. Aerial photography is supplied by AEROmetrix Pty Ltd and NearMap Pty Ltd. While every effort has been made to ensure the accuracy of the map, the City Council accepts no responsibility for any errors or omissions. My feedback on errors or omissions would be appreciated. No part of this map may be copied or reproduced in any form.

June 2018

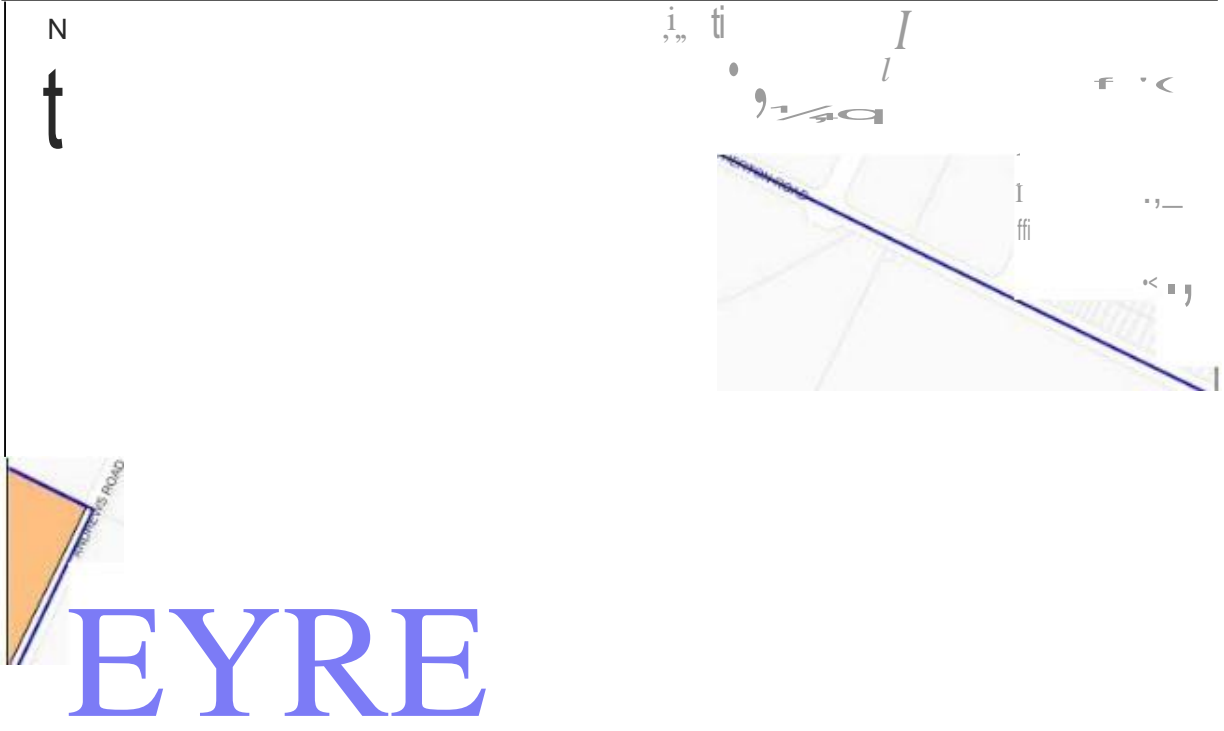

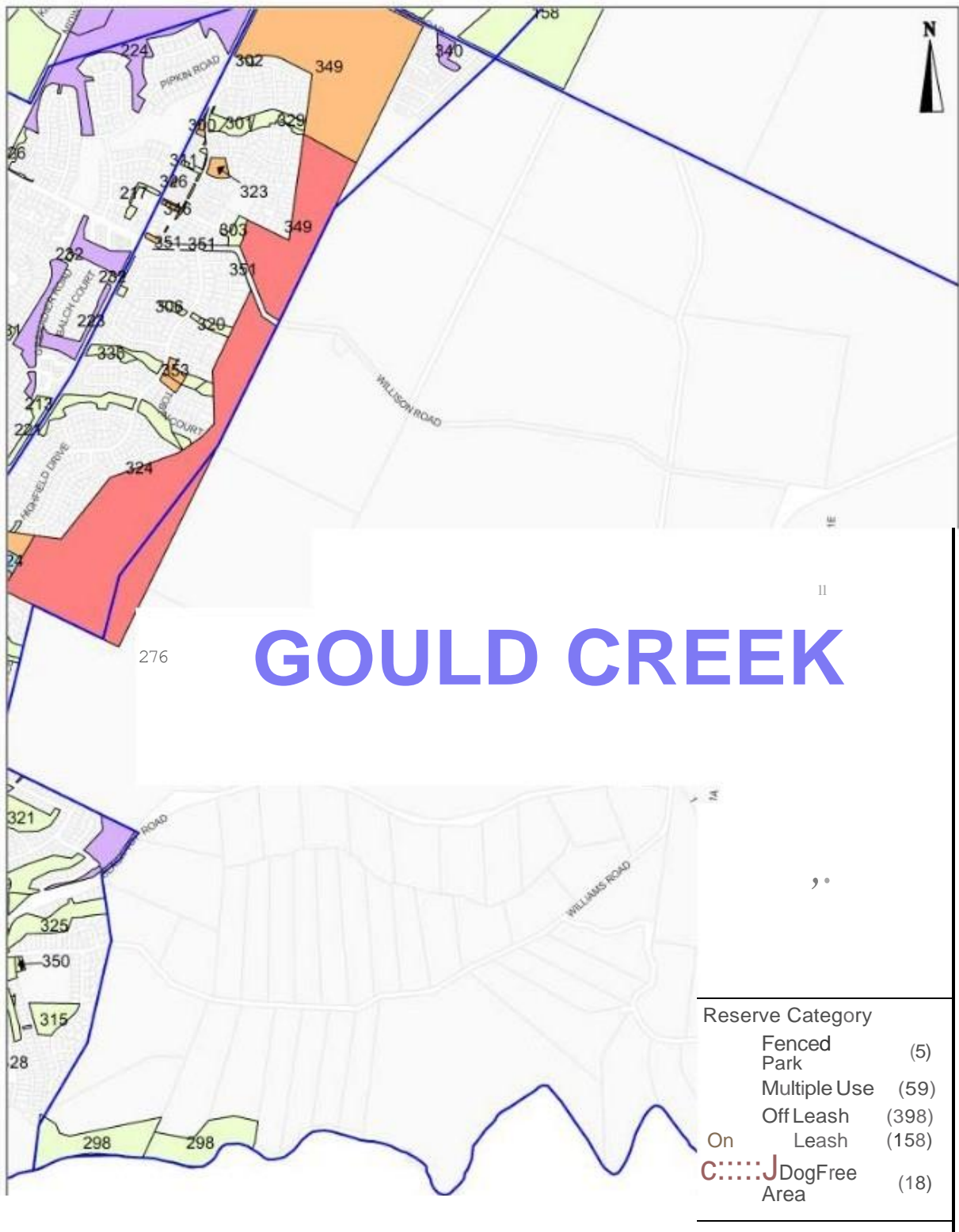

This map is a representation of the information generated by The City of Playford Cadastral and Roads. It is not a legal document and should not be used for legal purposes. The City of Playford is not responsible for any errors or omissions in this map. The City of Playford is not responsible for any damage or loss resulting from the use of this map. The City of Playford is not responsible for any copyright infringement or other legal issues arising from the use of this map. The City of Playford is not responsible for any other legal issues arising from the use of this map.

June 2018

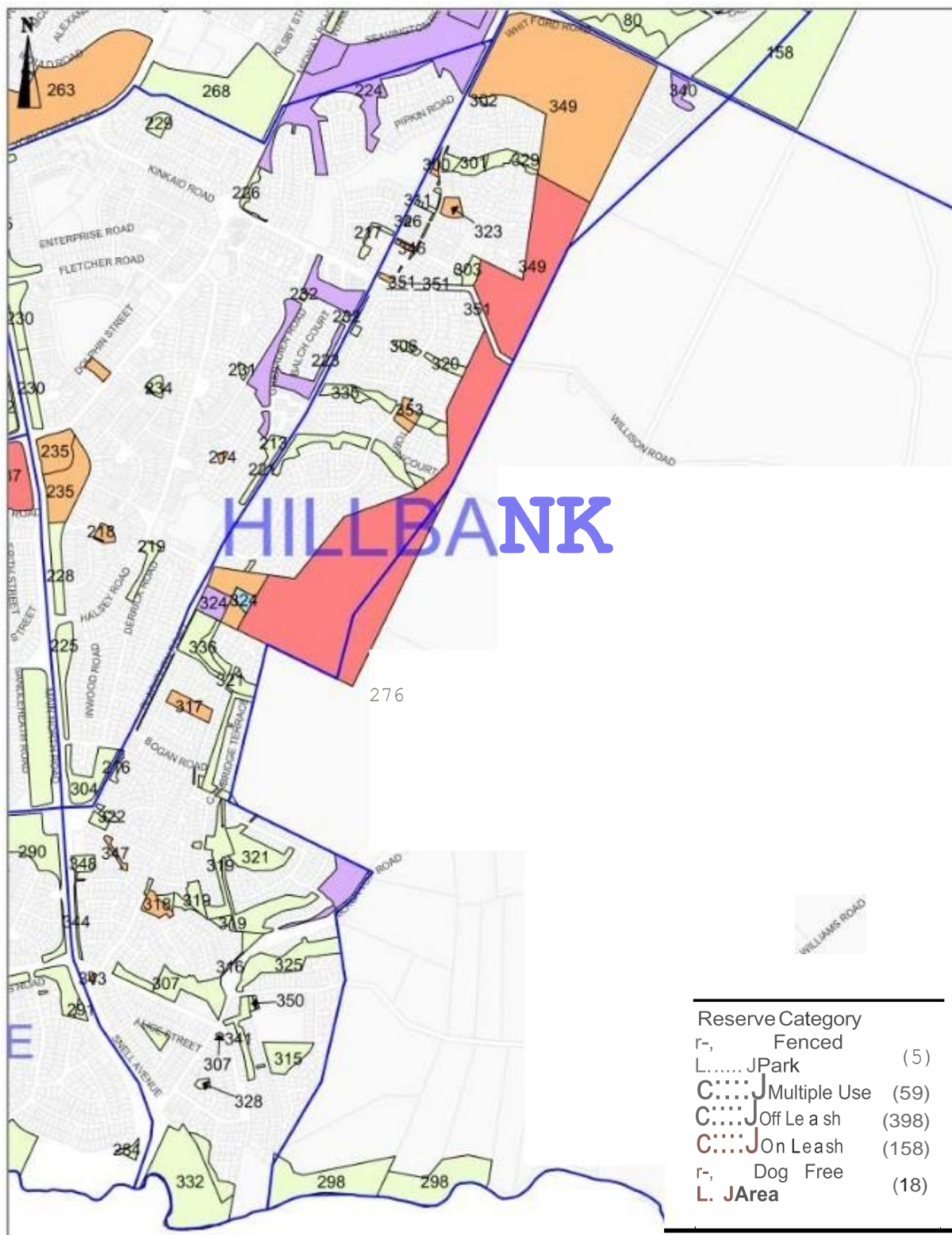

Q'l,.-,i-

This map is a representation of the information currently held by The City of Playford. cadastre, roads, suburbs, wards and local government areas are supplied by the Department of Environment and Natural Resources. All photography is supplied by AEROMETEX Pty Ltd and NearMap Pty Ltd. While every effort has been made to ensure the accuracy of the product, the council accepts no liability for any errors or omissions. Early feedback on any errors would be appreciated. No part of this map may be copied or reproduced in any form.

June 2018

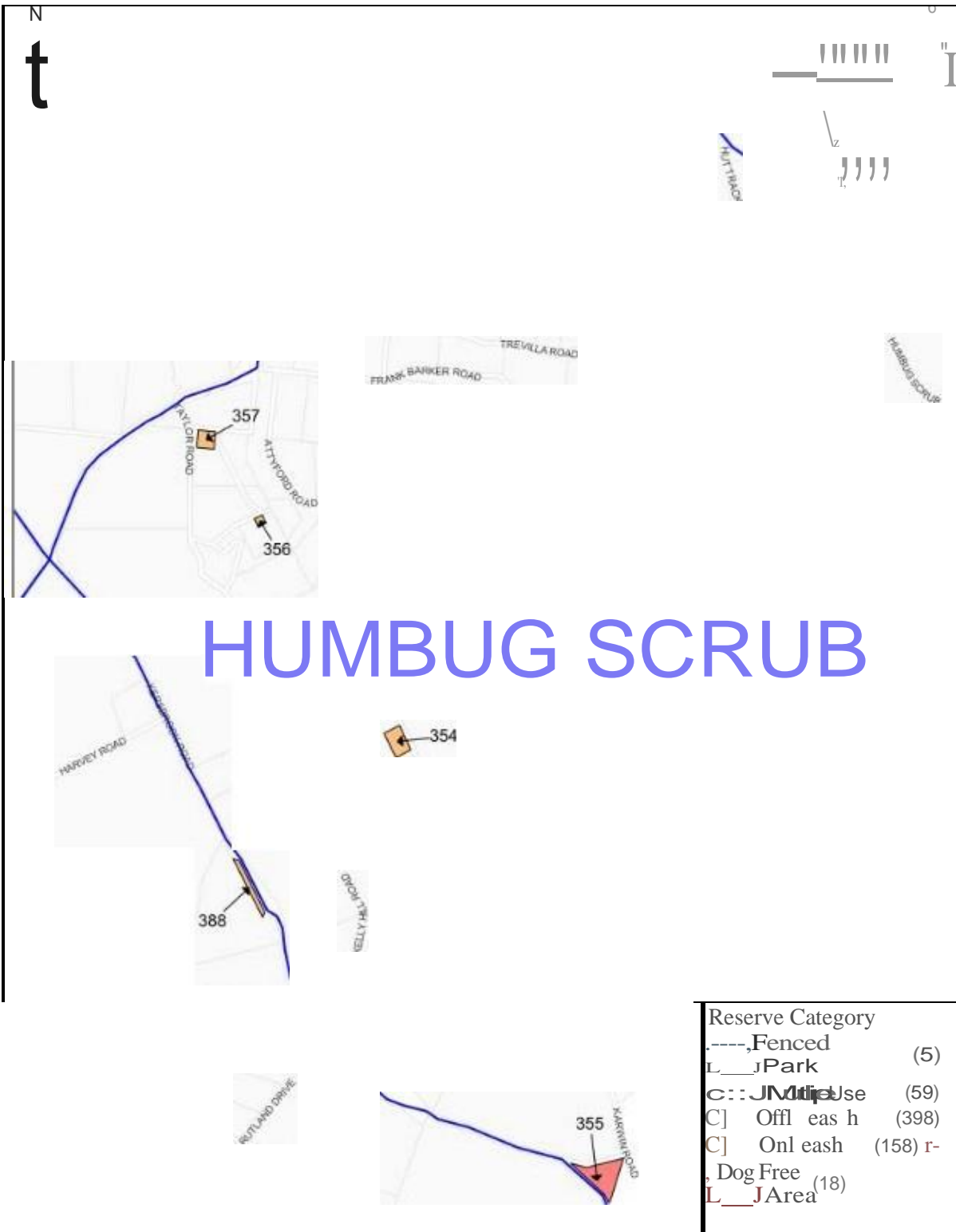

Reserve Category	
-----, Fenced	(5)
L___, Park	
C:::J, Mtd Use	(59)
C] Offl eas h	(398)
C] Onl eash	(158) r-
Dog Free	(18)
L___, Area	



This map is a representation of the information currently held by The City of Playford. It is not a guarantee of accuracy. The City of Playford is not responsible for any errors or omissions. Any feedback or comments should be sent to the City of Playford. No part of this map may be reproduced or stored in a retrieval system without the prior written permission of the City of Playford.

June 2018



MWU'ITTIWAY



MUNNO PARA WEST



Reserve Category

---	Fenced	(5)
L-i	Park	(59)
D	Multiple Use	(398)
""D	offLeash	(158)
c::::J	Onl eas h	(18)
D	Dog Free Area	



This map is a representation of the information currently held by The City of Playford. The City of Playford is not responsible for any errors or omissions in this map. The City of Playford is not responsible for any errors or omissions in this map. The City of Playford is not responsible for any errors or omissions in this map.

June 2018

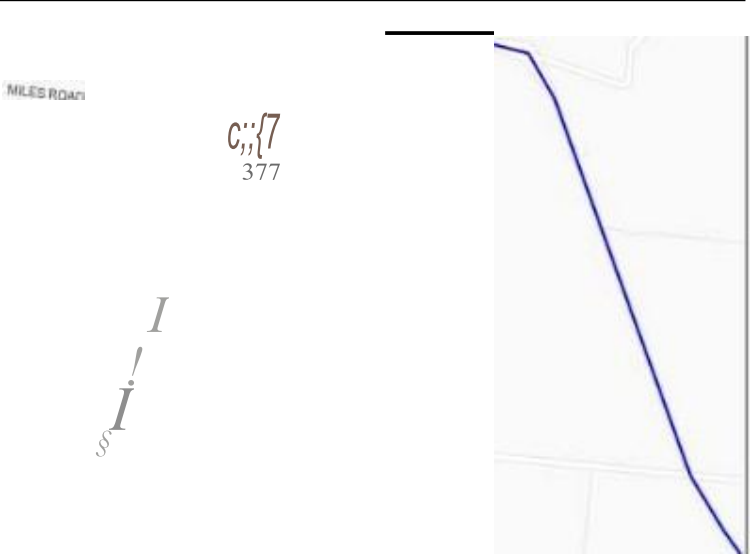

WALTERS ROAD



df379

ONE TREE HILL



JOHNSON ROAD



PAINES ROW



Reserve Category	
-----, Fenced	
L-1	(5)
t=!	Multiple Use (59)
t=!	Off Leash (398)
C)	On Leash (158)
t=!	Dog Free Area (18)



This map is a representation of the information held by the City of Playford. It is not a legal document and should not be used for legal purposes. The map is a representation of the information held by the City of Playford. It is not a legal document and should not be used for legal purposes. The map is a representation of the information held by the City of Playford. It is not a legal document and should not be used for legal purposes.

June 2018

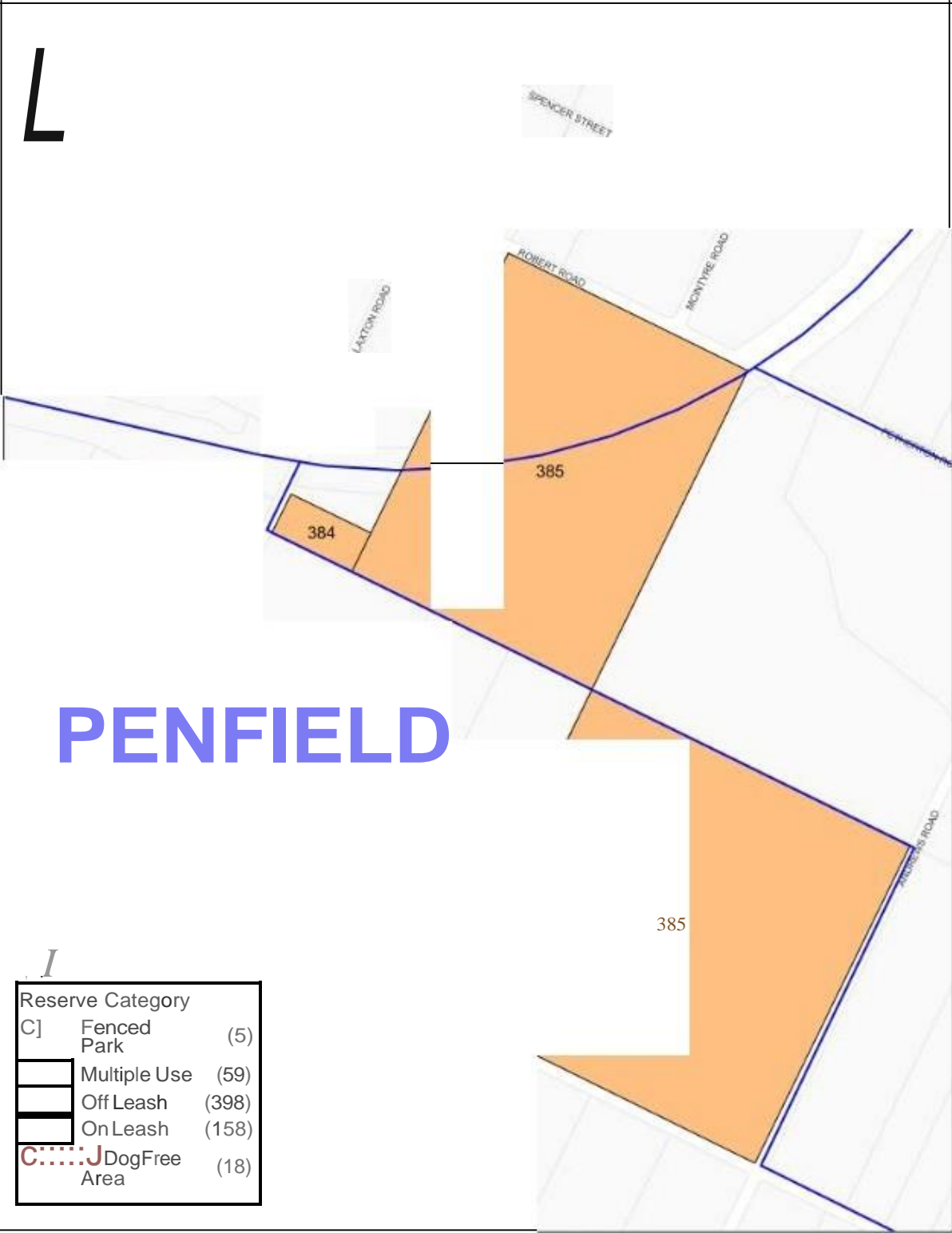

This map 15a represents information currently held by The City of Playford. It is not a legal document and should not be used for legal purposes. The City of Playford is not responsible for any errors or omissions in this map. The City of Playford is not responsible for any damage or loss resulting from the use of this map. The City of Playford is not responsible for any copyright infringement or other legal issues arising from the use of this map. The City of Playford is not responsible for any other legal issues arising from the use of this map.

June 2018

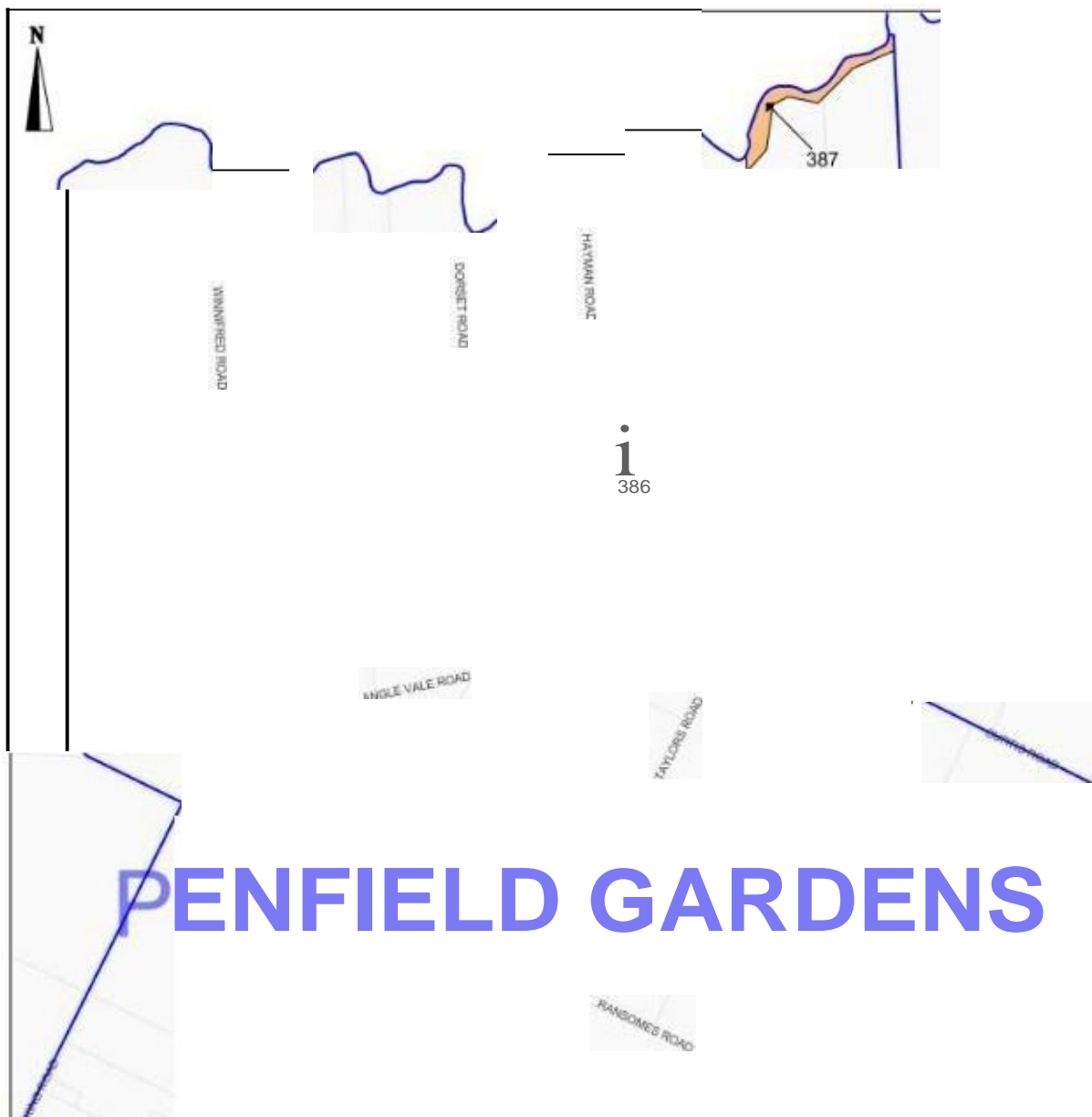

PENFIELD GARDENS



Reserve Category		
	Fenced	(5)
	Park	
	Multiple Use	(59)
	Off Leash	(398)
	On Leash	(158)
	Dog Free	(18)
	Alea	



This map is a representation of the information currently held by the City of Payfield. Cadastral, roads, suburbs, waters and local government areas are supplied by the Department of Environment, Water and Natural Resources (DEWNR) and the Department of Transport and Main Roads (DTMR). The City of Payfield does not accept any responsibility for any errors or omissions. My feedback or comments are appreciated. No part of this map may be copied or reproduced in any form.

July 2018

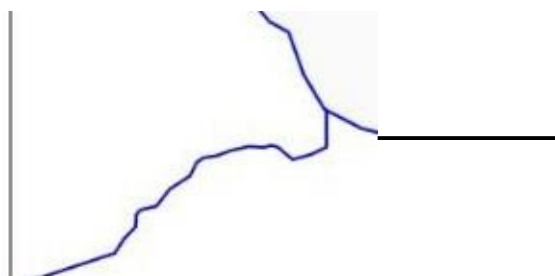
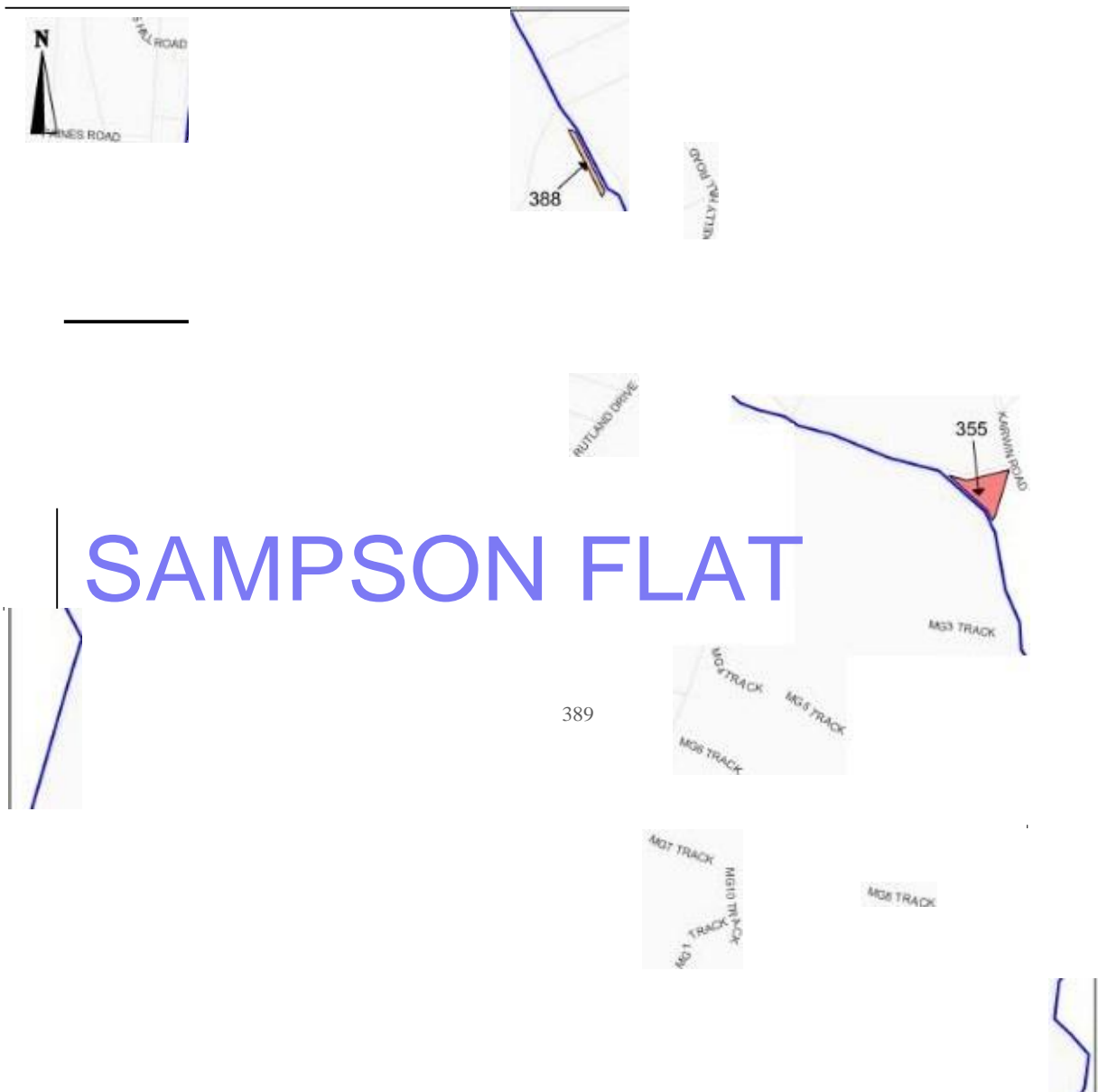

Reserve Category

i=J	Fenced Park	(5)
i=J	Multiple Use	(59)
i=J	Off Leash	(398)
i=J	on Leash	(158)
C:.....J	Dog Free Area	(18)



This map is a representation of the information currently held by The City of Playford. Cadas, tre, ro&i.et9 subur bs, 'l\&ldSand lOca'govem areasare ed by C!18 Departne'l!llo 1En ent.Wate- and NatlJl'.i Re AerialPt.:itograc:ihyis suwliodby AEROmotrexpty LtdandNea.rm.a;>Plyl.td'Muleeveryel'rQf1hH'boen l!l'Wldt 10tnwrt!tit d thtproclvct. ColJl'lCllacioapl:Sno r*SpO'lllililify to, anyerrorsoromi!..Sior\'.S.My feedback:konomissionsorerrorswoI.Adbeapp,eciatiad.. No partC!CM mapmzybe copiedorreproduced n anyform.

June 2018



This map is a representation of the information currently held by The City of Playford. The City of Playford is not responsible for any errors or omissions in the map. The City of Playford is not responsible for any errors or omissions in the map. The City of Playford is not responsible for any errors or omissions in the map.

June 2018

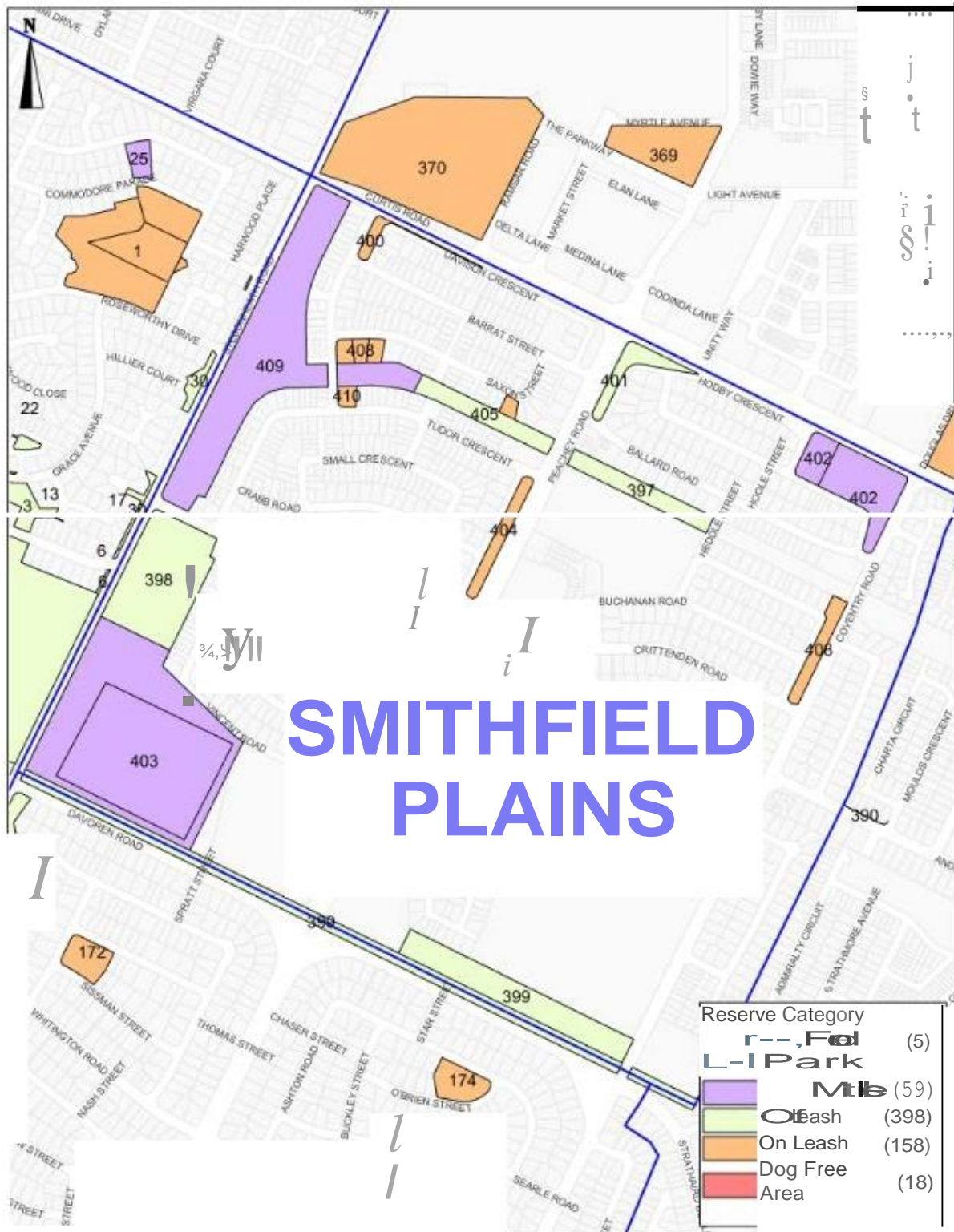

This map is a representation of the information currently held by The City of Playford. It is not a legal document and should not be used for legal purposes. The City of Playford is not responsible for any errors or omissions in this map. The City of Playford is not responsible for any errors or omissions in this map. The City of Playford is not responsible for any errors or omissions in this map.

June 2018

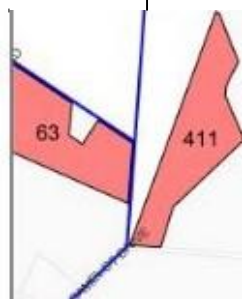

ULEYBURY



1



SI ARSOULO'

Reserve Category		
---	Food	(5)
---	JPark	(5)
---	Multiple Use	(59)
---	Off eas h	(398)
---	Onl eash	(158)
---	Dog Free	(18)
---	JArea	(18)

This map is a representation of the Woorretoo currently held by The City of Playford. Cadastre, roact9, suburb, s\\al\\ds and iO: al government 11 areas are 6q) led by the Department 011; y. ronment. Vial. el" Natural Resource\$ Aerial Pilet. ogaotr; iS tu iced by AE. ROMotreX Pty Ltd and NcO: JM. .pty Ltd W'tiilo •ryeffor 1M\$ Qeen mad• 10trn Sitt d ielo CO, llacy Cllht product Col, ll' Cil JOCe Pts t. > t* t* p) nability. any eFTOIS 0< omi 5 Son.s My feedback ll oo omission; or e«ot's wcd d be appreciated. No panoC s map may be copied o< repn. Cfuoed n any form.

June 2018

N



LEGGE ROAD

VIRGINIA



SHEDDY ROAD

, 0-- - 13

CLARET AVENUE
CORATVA ROAD

PENFIELD ROAD

Reserve Category		
r--	Fenced	
L_J	Pak	(5)
C]	MultipleUse	(59)
C]	Off Leash	(398)
C]	On Leash	(158)
r--	Dog Free	
L_J	Area	(18)



This is a representation of the information currently held by The City of Playford. Cadastral, road, and other information is provided for general information only. It is not to be used for any purpose other than that for which it was provided. The City of Playford is not responsible for any errors or omissions in this information. No part of this map may be copied or reproduced in any form.

June 2018



YATTALUNGA



Reserve Category	
c:=JFree	(5)
c:=JFree	Park
c:=JFree	Use (59)
c:=JFree	Leash (398)
c:=JFree	Leash (158)
c:=JFree	Dog Free Area (18)



This map is a representation of the information currently held by The City of Playford. It is not a legal document and should not be used for legal purposes. The City of Playford is not responsible for any errors or omissions in this map. The City of Playford is not responsible for any errors or omissions in this map. The City of Playford is not responsible for any errors or omissions in this map.

June 2018

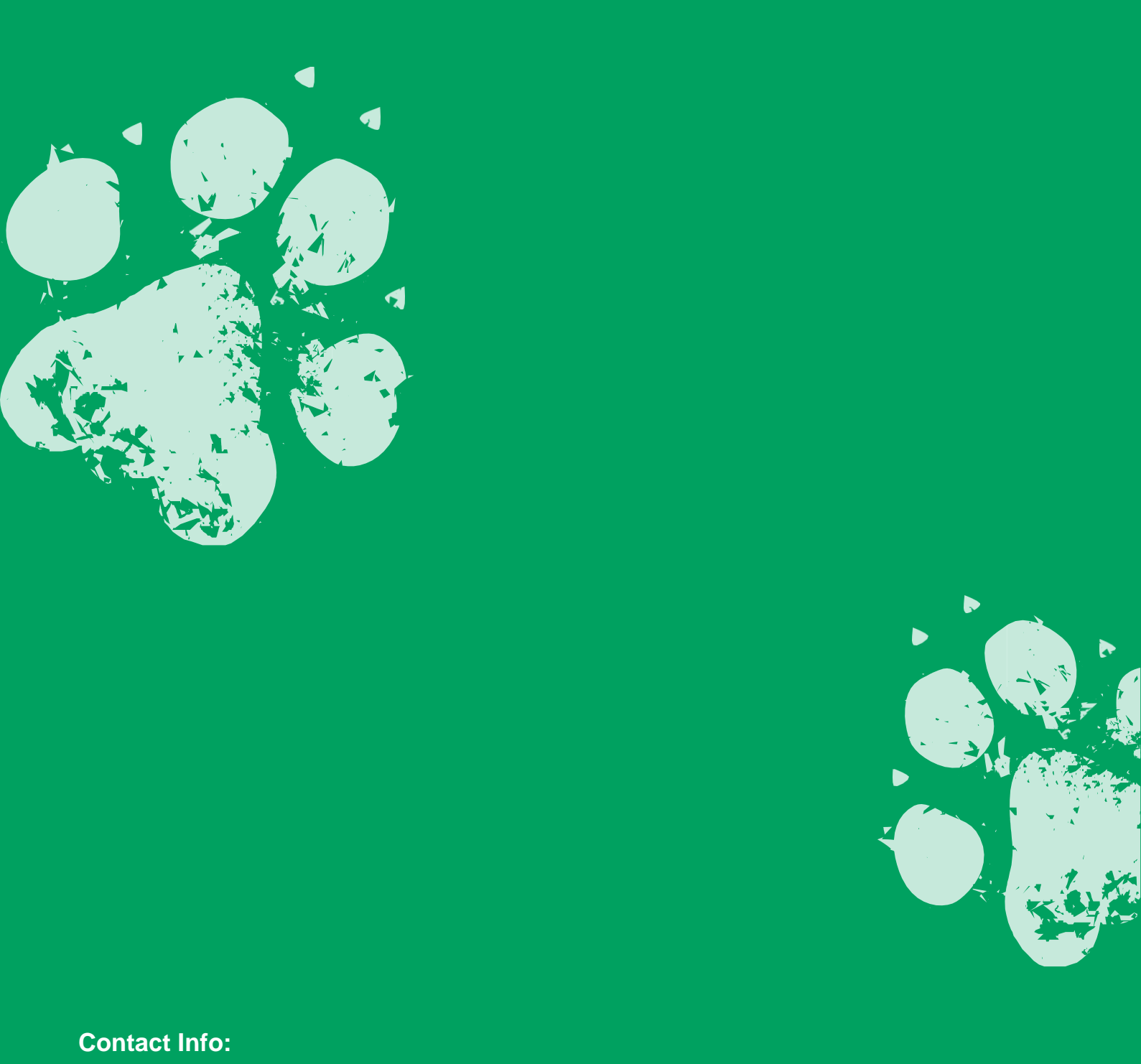

Contact Info:

CALL

(08) 8256 0333

VISIT

Playford Civic Centre
10 Playford Boulevard
Elizabeth SA 5112

Stretton Centre
307 Peachey Road
Munno Para SA 5115

POST

12 Bishopstone Road
Davoren Park SA 5113

EMAIL

playford@playford.sa.gov.au



playford.sa.gov.au